

**Amendment # LOC2002-0083**  
**Bylaw # 11Z2003**  
Council Approval: January 20 2003

**SCHEDULE B**

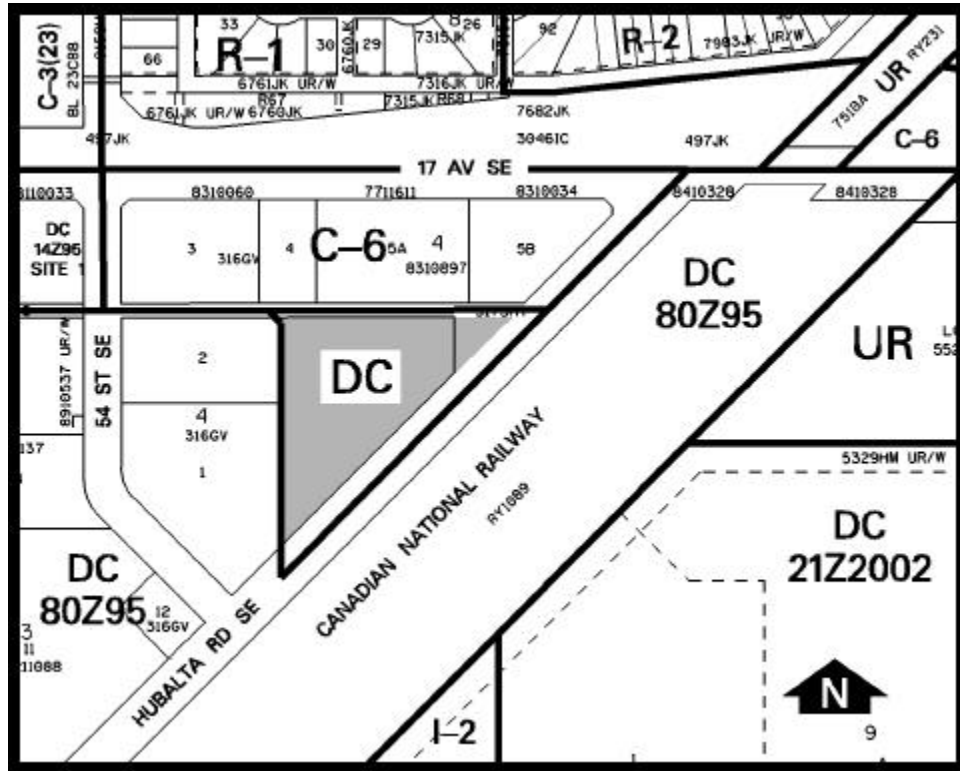

**DC DIRECT CONTROL DISTRICT**

1. Land Use

The Permitted and Discretionary Uses of the I-2 General Light Industrial District of Bylaw 2P80, shall be the Permitted and Discretionary Uses respectively with the additional Discretionary Uses of funeral homes, medical clinics, personal service businesses, retail food stores, retail stores, restaurants/drinking establishments, restaurants – food service only, outdoor cafes, neighbourhood shopping centres and free standing identification signs and with the following commercial uses excluded:

- adult mini-theatres
- billiard parlours
- gaming establishments – casino
- special care facilities

2. Development Guidelines

The General Rules for Industrial Districts contained in Section 43 of Bylaw 2P80 and the Permitted and Discretionary Use Rules of the I-2 General Light Industrial District shall apply unless otherwise noted below:

(a) Building Massing and Design

Blank walls should be avoided by the addition of a variety of detailing in wallfaces and roofs. Window treatment, detailing materials, and colour that is compatible with surrounding uses, is required.

(b) Signage

In addition to the requirements of the Signs – Appendix in Bylaw 2P80, signage shall meet the sign policies identified in paragraph 3.3.1.3.2.c of the Forest Lawn-Forest Heights/Hubalta Area Redevelopment Plan.