

**Amendment # LOC2002-0120**  
**Bylaw # 24Z2003**  
Council Approval: March 10 2003

**SCHEDULE B**

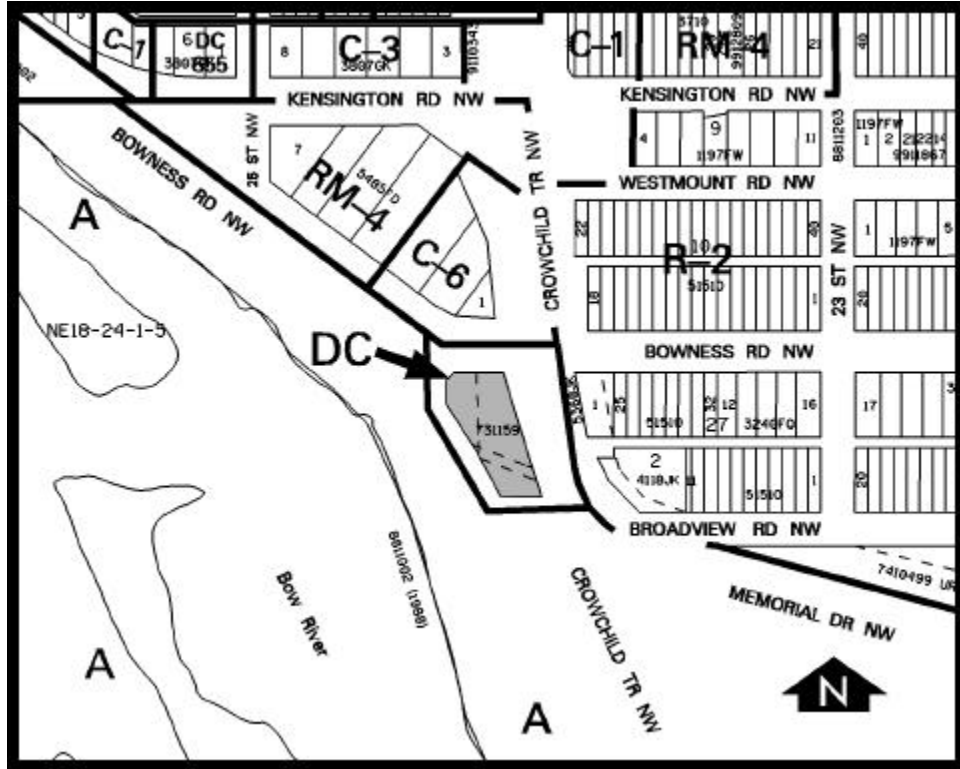

**DC DIRECT CONTROL DISTRICT**

1. Land Use

The Permitted and Discretionary Uses of the A Agricultural and Open Space District of Bylaw 2P80 shall be the Permitted and Discretionary Uses respectively with the additional Discretionary Uses of offices, warehousing and a homeless shelter within the building existing on site on the date of passage of this bylaw.

For the purpose of this bylaw, "homeless shelter" shall mean a facility providing temporary sleeping accommodation for homeless people which is operated in accordance with the detailed operational parameters submitted in conjunction with a development permit for the proposed use.

2. Development Guidelines

The General Rules for Special Districts contained in Section 48 of Bylaw 2P80 and the Permitted and Discretionary Use Rules of the A Agricultural and Open Space District shall apply except as otherwise noted below:

(a) Homeless Shelter

- (i) A development permit for a homeless shelter shall not be issued for a term extending for more than two (2) years beyond the issue of a Development Completion Permit which allows the building to be occupied as a homeless shelter. Thereafter no further development permits shall be issued for a homeless shelter.
- (ii) Any development permit application for a homeless shelter shall be accompanied by detailed operational parameters satisfactory to the Development Authority which shall form part of the permanent conditions of approval for that application.
- (iii) Capacity of the facility shall not exceed 150 clients.

(b) Development Plans

Approval of this bylaw does not constitute approval for a development permit. Comprehensive plans shall be submitted to the Development Authority as part of a development permit application.