

**Amendment # LOC2002-0105**  
**Bylaw # 46Z2003**  
Council Approval: 2003 May 26

**SCHEDULE B**

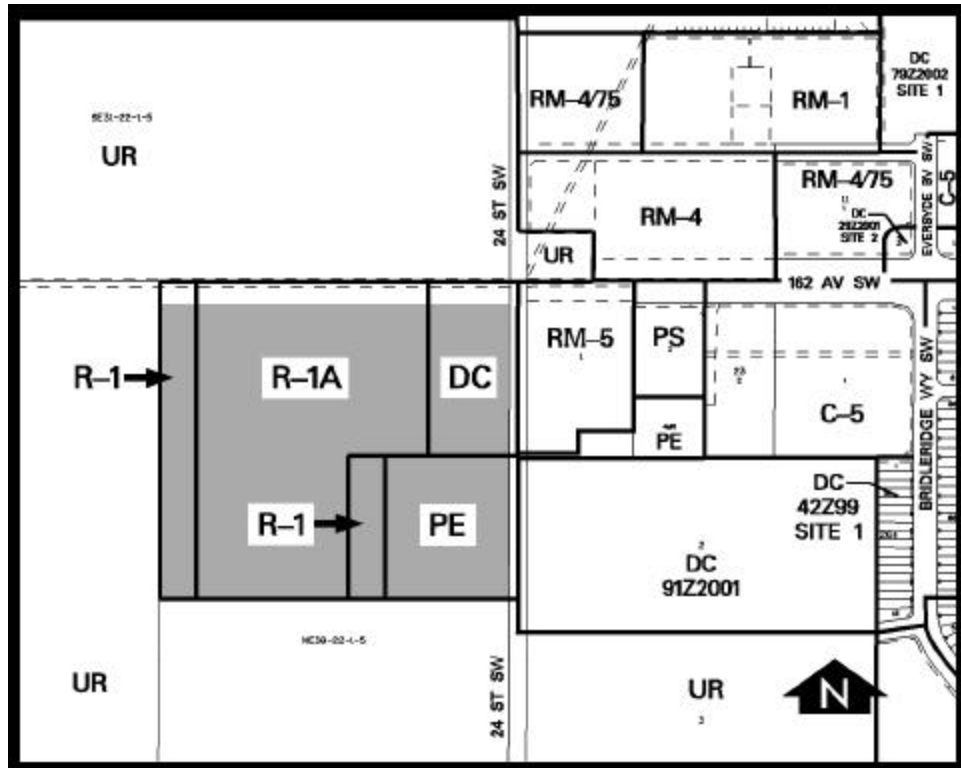

**DC DIRECT CONTROL DISTRICT**

1. Land Use

The Permitted and Discretionary Uses of the RM-5 Residential Medium Density Multi-Dwelling District of Bylaw 2P80 shall be the Permitted and Discretionary Uses respectively.

2. Development Guidelines

The General Rules for Residential Districts contained in Section 20 of Bylaw 2P80 and the Permitted and Discretionary Use Rules of the RM-5 Residential Medium Density Multi-Dwelling District shall apply unless otherwise noted below:

(a) Density

A maximum of 162 units per hectare (66 units per acre).