

Amendment # LOC2003-0040 Bylaw # 98Z2003

Council Approval: 2004 April 19

SCHEDULE B

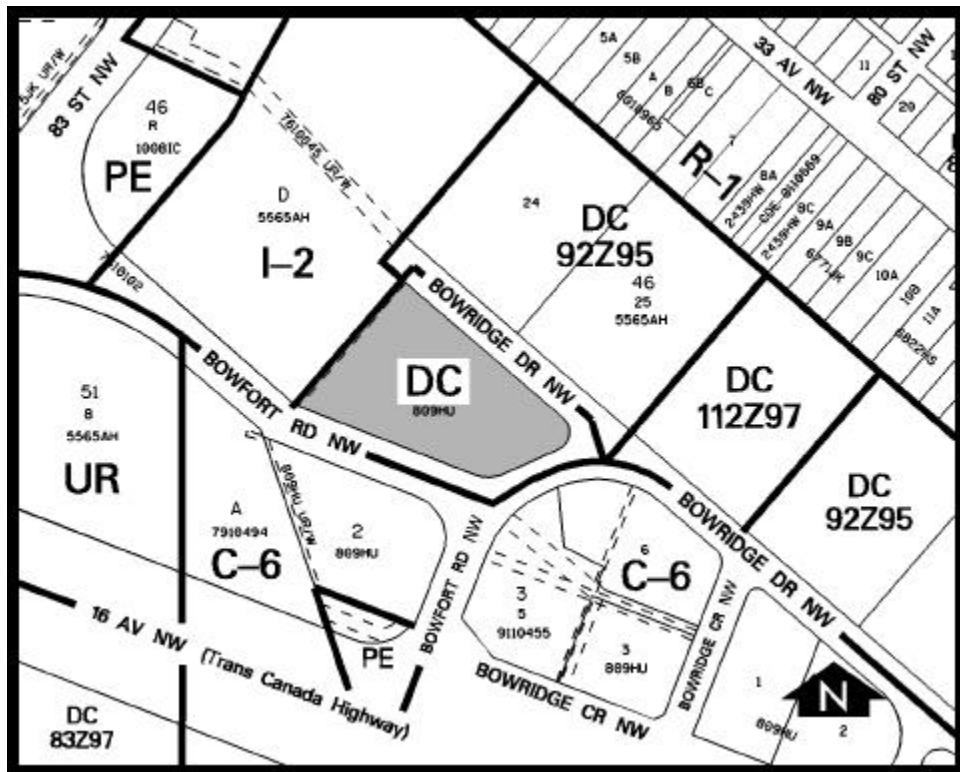

DC DIRECT CONTROL DISTRICT

1. Land Uses

The Permitted Use shall be for a hotel including a restaurant/drinking establishment.

2. Development Guidelines

The General Rules for Commercial Districts contained in Section 33 of Bylaw 2P80 and the Permitted and Discretionary Use Rules of the C-6 Highway Commercial District shall apply except as amended or replaced below:

(a) Front Yard

A minimum depth of 3 metres.

(b) Floor Area

(i) Restaurant/drinking establishment

A maximum net floor area of 224 square metres, excluding kitchen area.

(c) Parking Stalls

The minimum number of on-site parking stalls provided for combined hotel, restaurant/drinking establishment uses shall be 156.

(d) Hotel Rooms

The maximum number of hotel rooms shall not exceed 121.

(e) Development Plans

Approval of this application does not constitute approval of a development permit. Comprehensive plans shall be submitted to the Approving Authority as part of a development permit application. In considering such an application, the Approving Authority shall ensure the building design and site layout substantially conform with the plans and renderings available to City Council during its consideration of this Bylaw.