

Amendment # LOC2003-0103
Bylaw # 13Z2004
Council Approval: 2004 February 09

SCHEDULE B

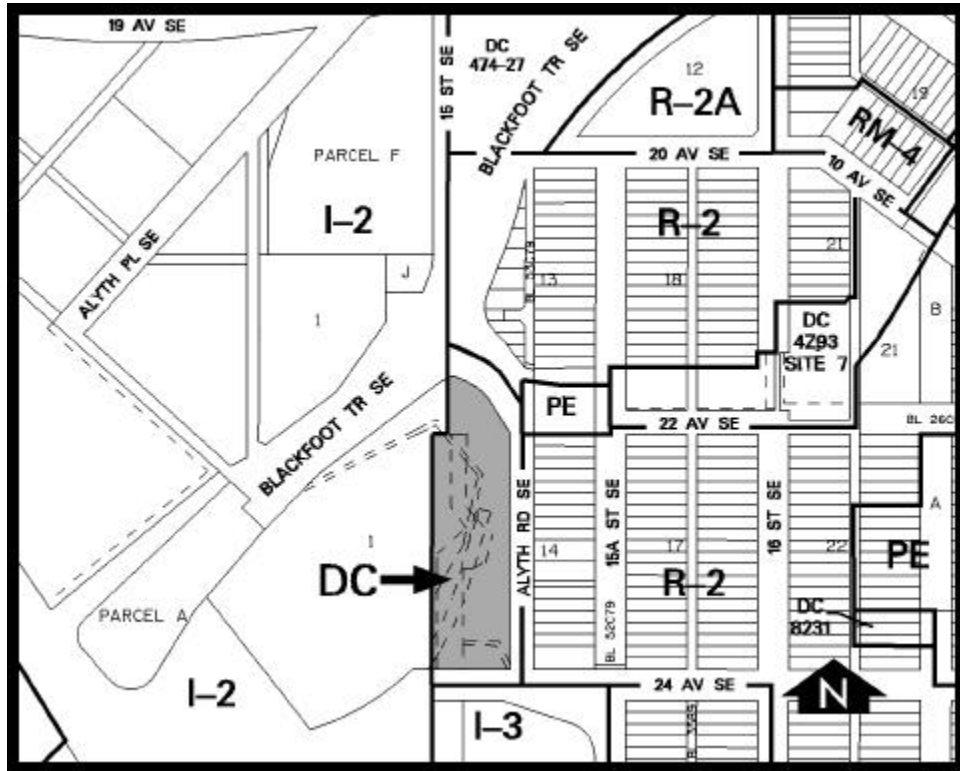

DC DIRECT CONTROL DISTRICT

1. Land Use

The Permitted Uses shall be:

Essential public services
Signs – Class 1
Utilities

The Discretionary Uses shall be:

Accessory food services
Accessory uses
Ancillary commercial uses
Athletic and recreation facilities
Auction halls

Amendment # LOC2003-0103 Bylaw # 13Z2004

SCHEDULE B

CONTINUED

- Child care facilities
- Cleaning, servicing, testing or repairing
- Commercial schools
- Financial institutions
- Flea Markets
- Greenhouses and nurseries
- Grocery stores
- Hotels and motels
- Liquor stores
- Manufacturing, fabricating, processing, assembly, disassembly, production, or packaging of materials, good or products
- Mechanical reproduction and printing establishments
- Motion picture production facilities
- Movement or storage of materials, goods or products
- Offices
- Outdoor café
- Outside storage
- Parking areas and structures
- Private clubs and organizations
- Private schools
- Public and quasi-public buildings
- Radio and television studios
- Restaurant/drinking establishments
- Restaurants-food service only
- Signs – Class 2
- Take-out food services
- Utility Building
- Veterinary clinics
- Veterinary hospitals
- Warehouse stores

2. Development Guidelines

The General Rules for Industrial Districts contained in Section 43 of Bylaw 2P80 and the Permitted and Discretionary Rules of the I-2 General Light Industrial District shall apply unless otherwise noted below:

(a) Outside Storage

In addition to the requirements of Section 45(3)(l) the following shall apply:

- (i) the use of outside storage shall be allowed only if it is related to the business or industry on that portion of Lot 16, Block1, Plan 0214144 immediately west

**Amendment # LOC2003-0103
Bylaw # 13Z2004**

SCHEDULE B

CONTINUED

of the land subject of this bylaw;

- (ii) the use of outside storage shall be screened from adjacent public thoroughfares and residential development to the east either by buildings or a solid architectural wall with landscape planting between the wall and east property line; and
- (iii) the use of outside storage shall only be allowed to a maximum height of 2.4 metres.