

**Amendment # LOC2003-0062**  
**Bylaw # 14Z2004**  
Council Approval: 2004 February 09

**SCHEDULE B**

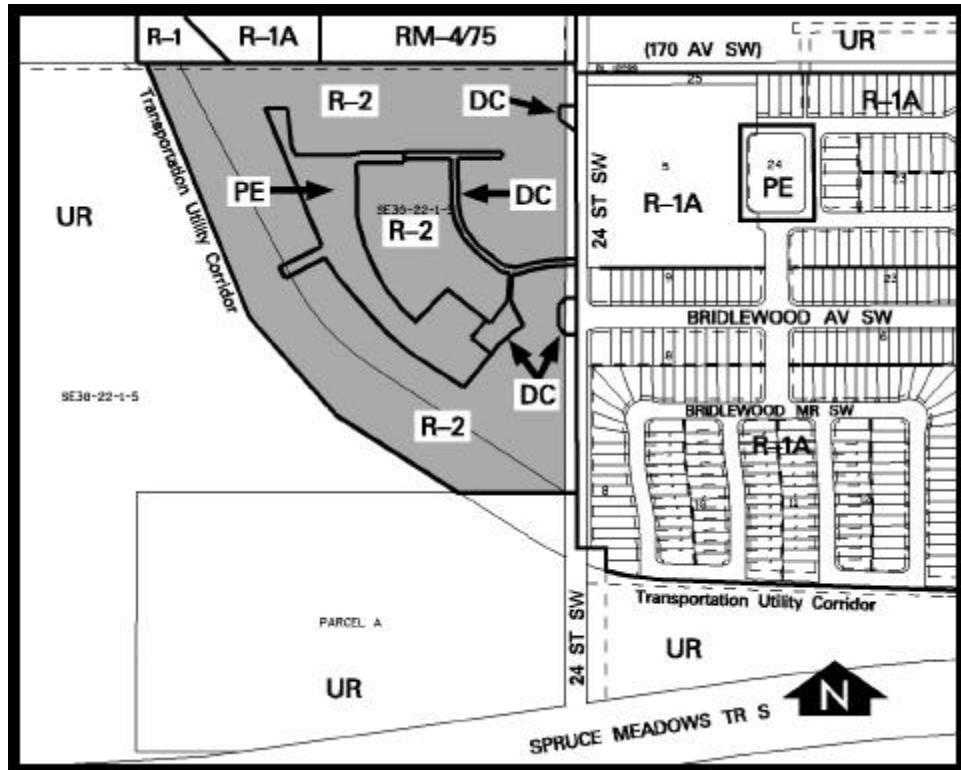

**DC DIRECT CONTROL DISTRICT**

1. Land Use

The Discretionary Uses shall be private walkways, entrance features and community identification signs.

2. Development Guidelines

The General Rules for Special Districts contained within Section 48 of Bylaw 2P80 and the Permitted and Discretionary Use Rules of the PE Public Park, School and Recreation District shall apply.