

BYLAW NO. 16D2008

**BEING A BYLAW OF THE CITY OF CALGARY
TO AMEND THE LAND USE BYLAW 1P2007
(LAND USE AMENDMENT LOC2008-0006)**

WHEREAS it is desirable to amend the Land Use Bylaw Number 1P2007 to change the land use designation of certain lands within the City of Calgary;

AND WHEREAS Council has held a public hearing as required by Section 692 of the Municipal Government Act, R.S.A. 2000, c.M-26 as amended;

NOW, THEREFORE, THE COUNCIL OF THE CITY OF CALGARY ENACTS AS FOLLOWS:

1. The Land Use Bylaw, being Bylaw 1P2007 of the City of Calgary, is hereby amended by deleting that portion of the Land Use District Maps shown as shaded on Schedule "A" to this Bylaw and substituting therefor that portion of the Land Use District Maps shown as shaded on Schedule "B" to this Bylaw, including any land use designation, or specific land uses and development guidelines contained in the said Schedule "B".
2. This Bylaw comes into force on June 1, 2008.

READ A FIRST TIME THIS 14th DAY OF APRIL, 2008.

READ A SECOND TIME AS AMENDED THIS 12th DAY OF MAY, 2008.

READ A THIRD TIME AS AMENDED THIS 12th DAY OF MAY, 2008.

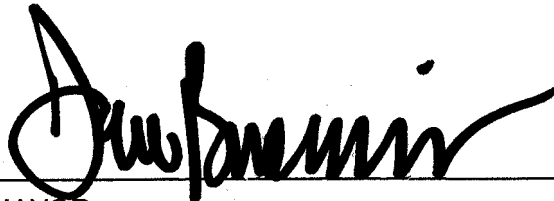

MAYOR
SIGNED THIS 5th DAY OF JUNE, 2008.



ACTING CITY CLERK
SIGNED THIS 5th DAY OF JUNE, 2008.

Amendment LOC2008-0006 Bylaw 16D2008

SCHEDULE A

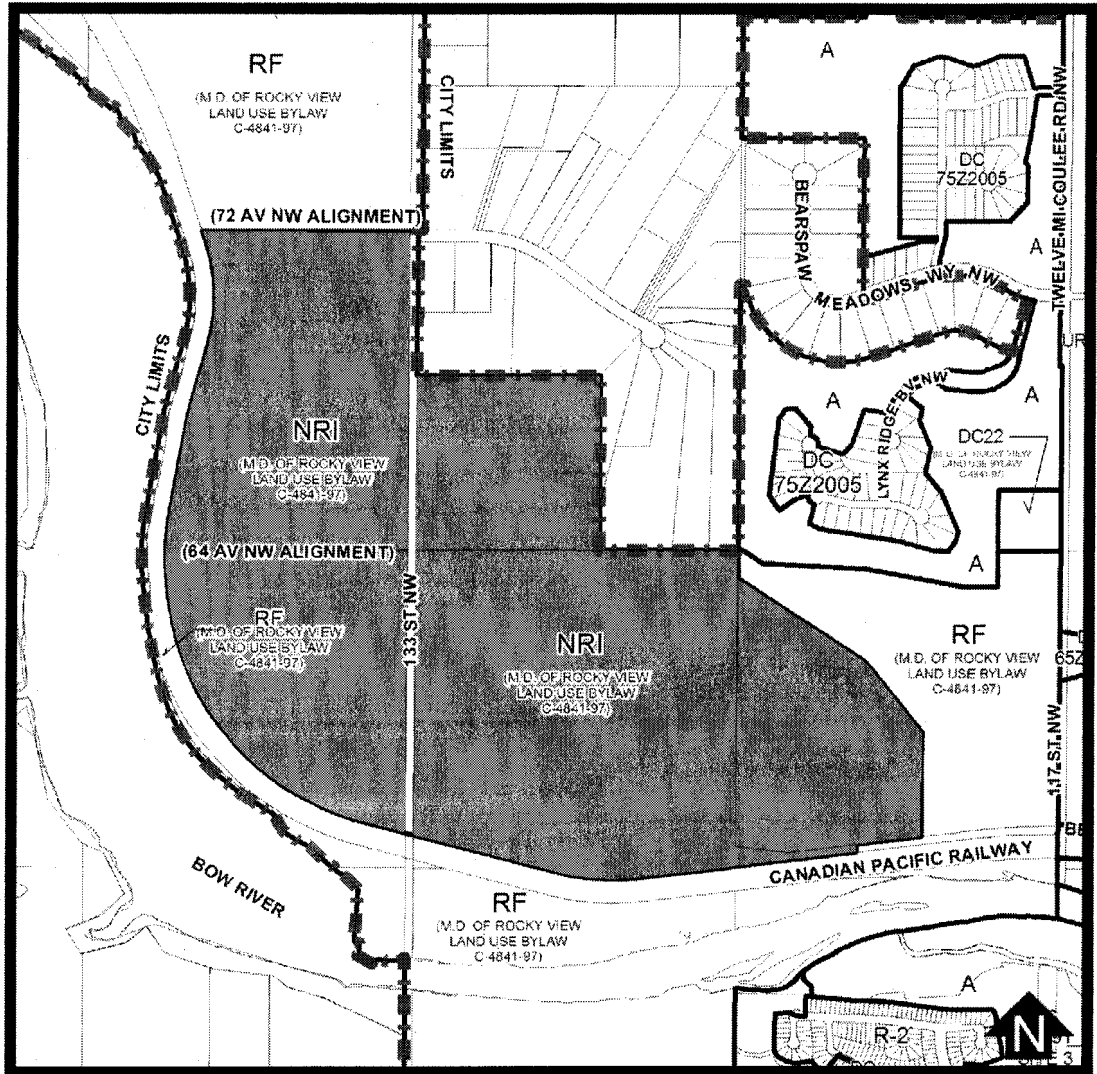

Amendment LOC2008-0006 Bylaw 16D2008

SCHEDULE A

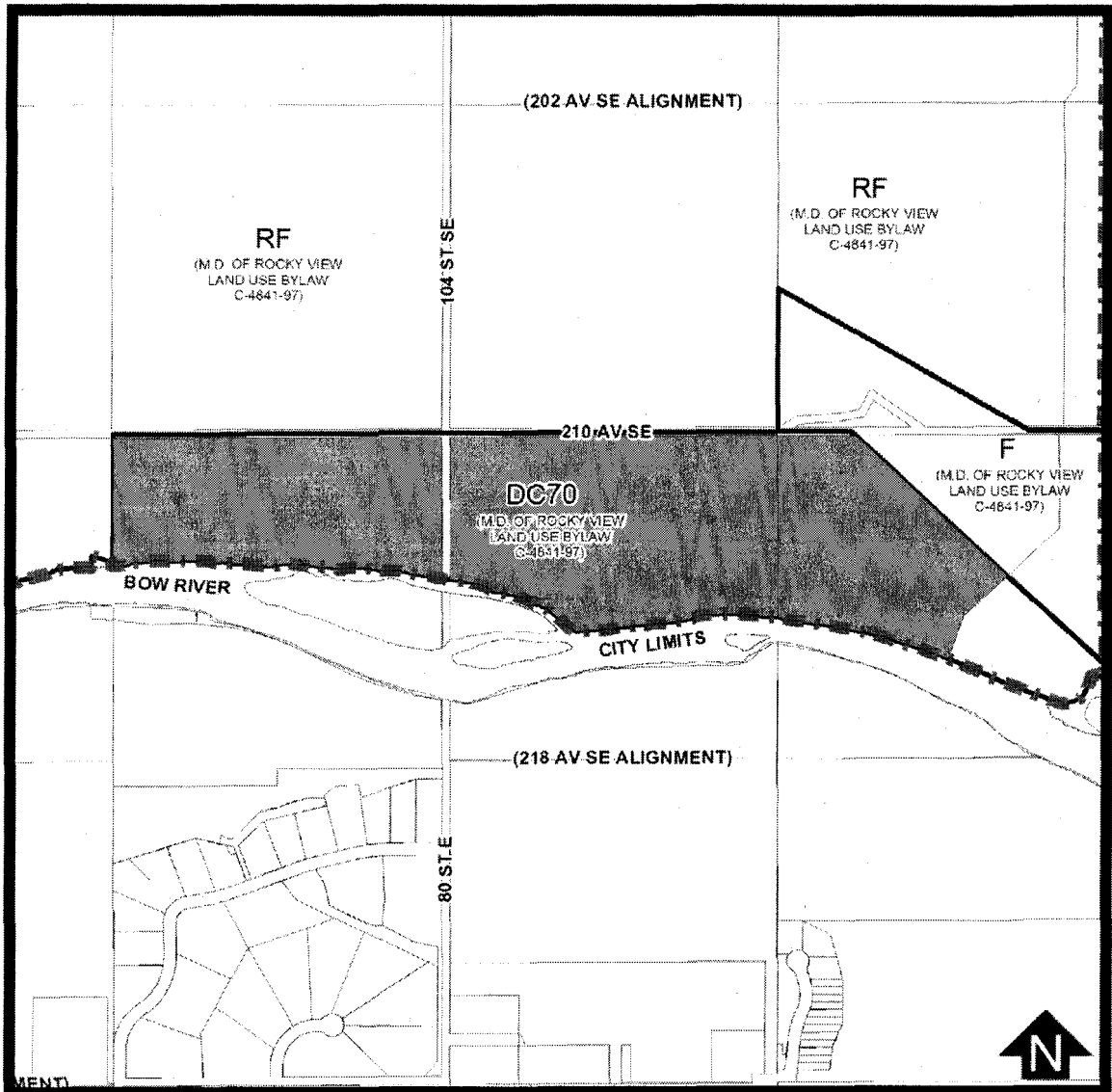

Amendment LOC2008-0006 Bylaw 16D2008

SCHEDULE B

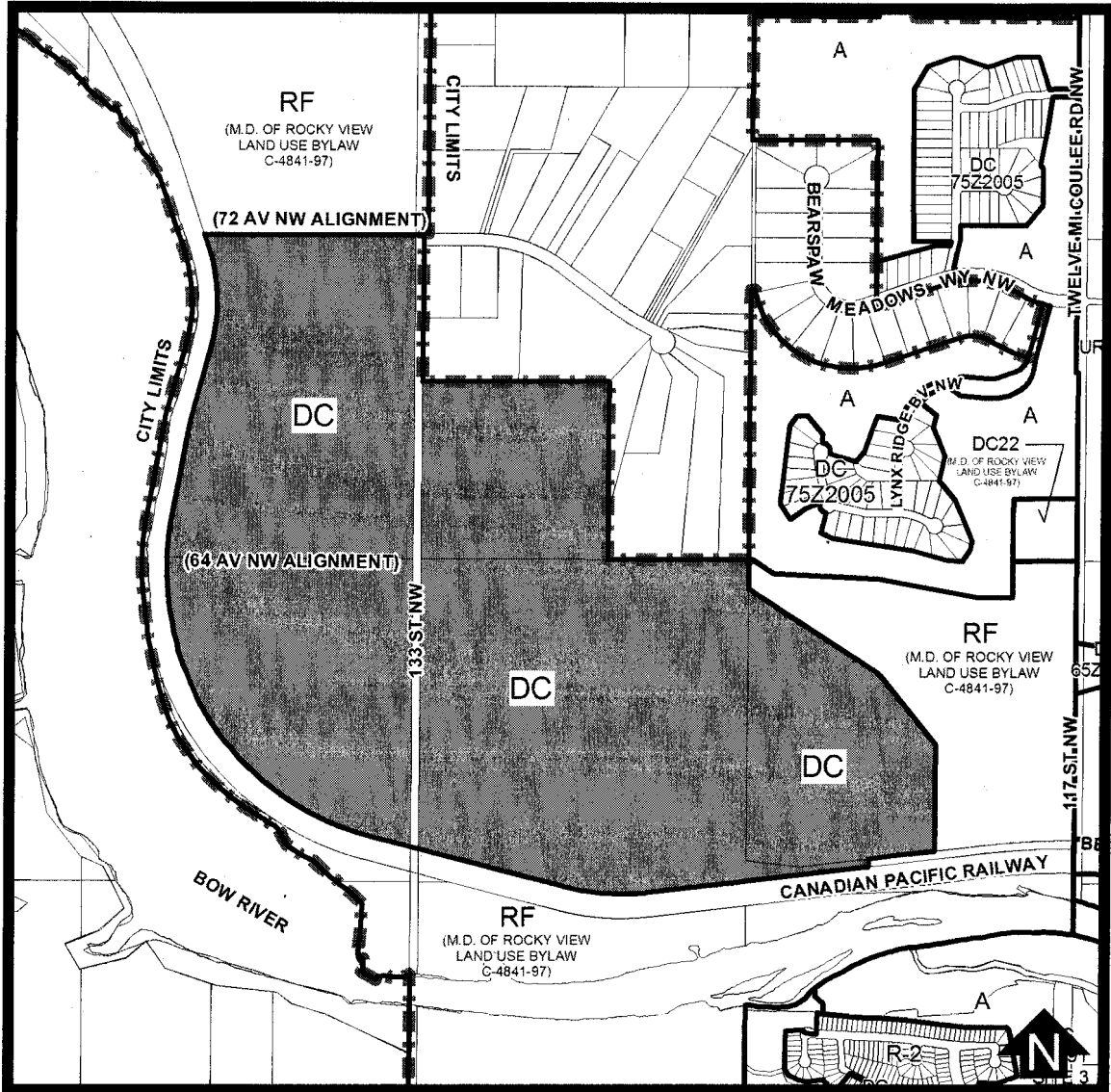

Amendment LOC2008-0006 Bylaw 16D2008

SCHEDULE B

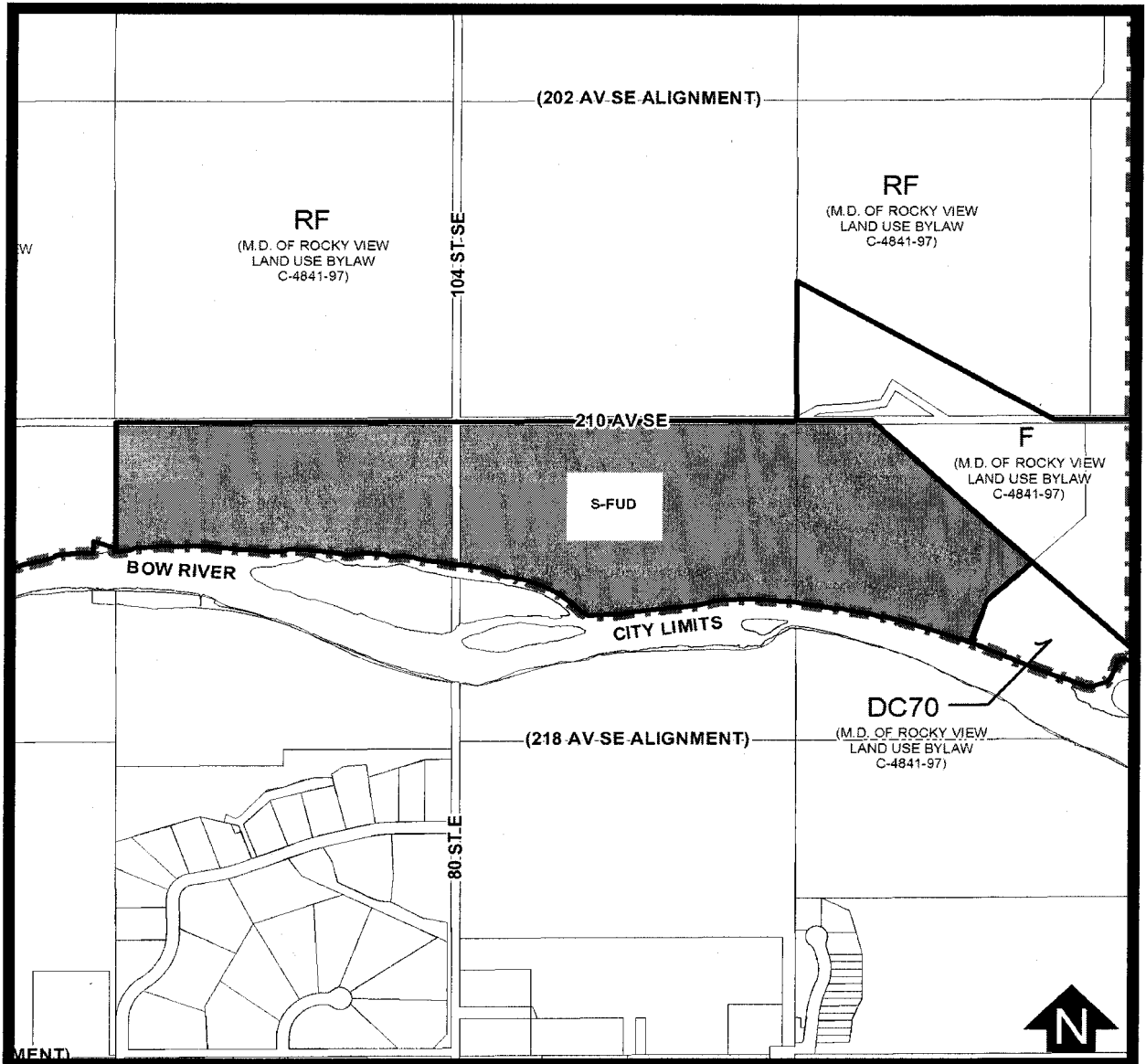

DC DIRECT CONTROL GUIDELINES

Purpose Statement

- 1 This Direct Control District is intended to be applied to **development** on lands that are under going **Asphalt, Aggregate, and Concrete Plant and Pits and Quarries** and related **uses**.

Amendment LOC2008-0006 Bylaw 16D2008

SCHEDULE B

Compliance with Bylaw 1P2007

- 2 Unless otherwise specified, the rules and provisions of Parts 1, 2, 3 and 4 of Bylaw 1P2007 apply.

Reference to Bylaw 1P2007

- 3 A reference to a section of Bylaw 1P2007 within this Bylaw is deemed to be a reference to the section as amended from time to time.

Site

- Site 1 – 187.81 ± hectares (464.09 acres)
Site 2 – 83.33 ± hectares (205.92 acres)

Permitted Uses

- 4 The ***permitted uses*** of the Industrial – Heavy (I-H) District of Bylaw 1P2007 apply with the addition of:
- (a) **Extensive Agriculture.**

Discretionary Uses

- 5 The following ***discretionary uses*** apply in this Direct Control Bylaw:
- (a) **Asphalt, Aggregate, and Concrete Plant; and**
 - (b) **Pits and Quarries.**

Bylaw 1P2007 District Rules

- 6 All rules contained in the Industrial – Heavy (I-H) District of Bylaw 1P2007 shall apply unless otherwise specified in this Bylaw.

BYLAW NO. 16D2008

ADVERTISED IN: Calgary Sun on Thursday March 20, 2008

BYLAW 16D2008

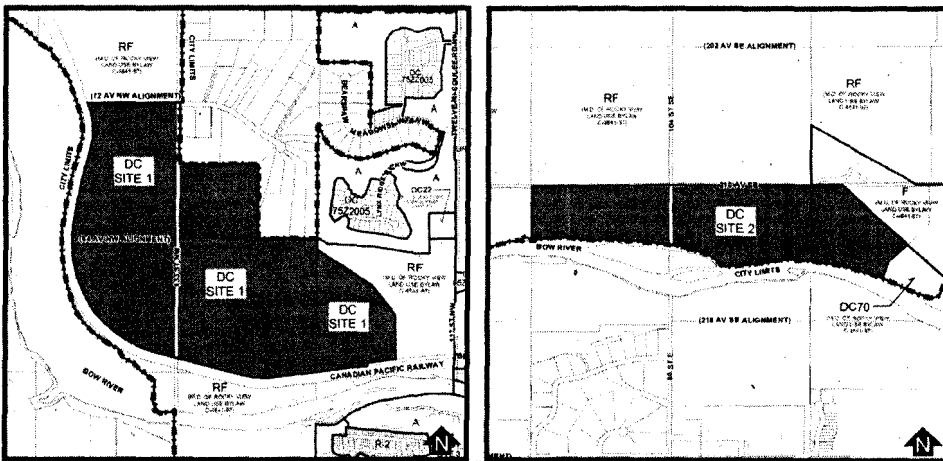

Street	Calgary Municipal Address	Legal Description	Existing MD of Rocky View Land Use District (C-4841-97)	Proposed City of Calgary Land Use District (1P2007)
104 St. SE	21117	PORTIONS OF 4;29;22;12;NE	DC	DC Site 2
133 St. NW	6000, 6005, 6600, 6815	1139HJ;A, PORTIONS OF 5;3;25;1;NE, 5126JK;D, PORTIONS OF 5;3;25;12;SE,	NRI, RF	DC Site 1
210 Ave. SE	11111, 11335	PORTIONS OF 4;28;22;7;NW, PORTIONS OF 4;28;22;7;NE	DC	DC Site 1
Bearspaw Dam Rd. NW	12400	7416JK;E	NRI	DC Site 1

LEGEND	
MD of Rocky View Land Use Districts	City of Calgary Land Use Districts
NRI Natural Resource Industrial District	DC Direct Control District
RF Ranch and Farm District	
DC Direct Control District	

BYLAW NO. 16D2008

ADVERTISED IN: Calgary Sun on Thursday March 27, 2008

BYLAW 16D2008

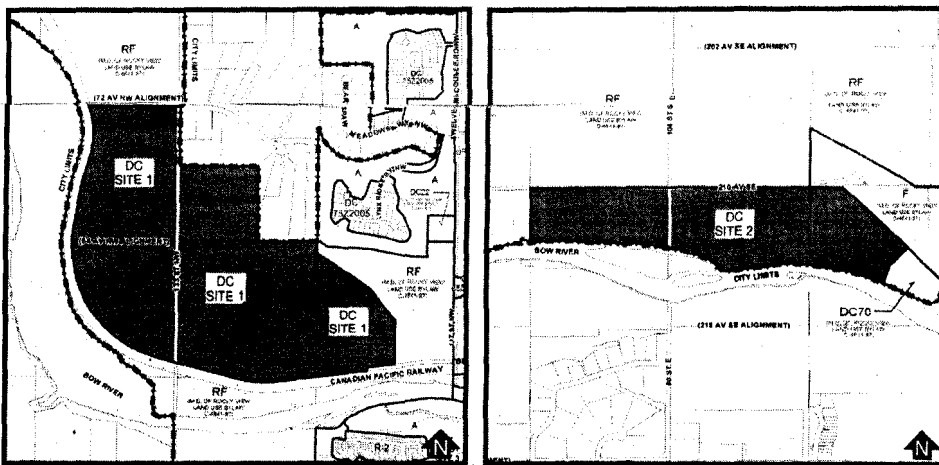

Street	Calgary Municipal Address	Legal Description	Existing MD of Rocky View Land Use District (C-4841-97)	Proposed City of Calgary Land Use District (1P2007)
104 St. SE	21117	PORTIONS OF 4;29;22;12;NE	DC	DC Site 2
133 St. NW	6000, 6005, 6600, 6815	1139HJ;A, PORTIONS OF 5;3;25;1;NE, 5126JK;D, PORTIONS OF 5;3;25;12;SE.	NRI, RF	DC Site 1
210 Ave. SE	11111, 11335	PORTIONS OF 4;28;22;7;NW, PORTIONS OF 4;28;22;7;NE	DC	DC Site 1
Bearspaw Dam Rd. NW	12400	7416JK;E	NRI	DC Site 1

LEGEND	
MD of Rocky View Land Use Districts	City of Calgary Land Use Districts
NRI Natural Resource Industrial District	DC Direct Control District
RF Ranch and Farm District	
DC Direct Control District	

TO: CITY CLERK
FROM: DEVELOPMENT AND BUILDING APPROVALS
RE: LUB/16D2008

=====

APPROVED AS TO CONTENT



IAN COPE
HEAD - ORIGINATING BUSINESS UNIT

APPROVED AS TO FORM



SHARI SHIGEHIRO
CITY SOLICITOR

BUDGET PROGRAM NO.
(if applicable)

DATE OF COUNCIL INSTRUCTION
(if applicable)
