

BYLAW NUMBER 18D2009

**BEING A BYLAW OF THE CITY OF CALGARY
TO AMEND THE LAND USE BYLAW 1P2007
(LAND USE AMENDMENT LOC2008-0089)**

WHEREAS it is desirable to amend the Land Use Bylaw Number 1P2007 to change the land use designation of certain lands within the City of Calgary;

AND WHEREAS Council has held a public hearing as required by Section 692 of the *Municipal Government Act*, R.S.A. 2000, c.M-26 as amended;

NOW, THEREFORE, THE COUNCIL OF THE CITY OF CALGARY ENACTS AS FOLLOWS:

1. The Land Use Bylaw, being Bylaw 1P2007 of the City of Calgary, is hereby amended by deleting that portion of the Land Use District Map shown as shaded on Schedule "A" to this Bylaw and substituting therefor that portion of the Land Use District Map shown as shaded on Schedule "B" to this Bylaw, including any land use designation, or specific land uses and development guidelines contained in the said Schedule "B".
2. This Bylaw comes into force on the date it is passed.

READ A FIRST TIME THIS 12th DAY OF JANUARY, 2009.

READ A SECOND TIME THIS 12th DAY OF JANUARY, 2009.

READ A THIRD TIME THIS 12th DAY OF JANUARY, 2009.

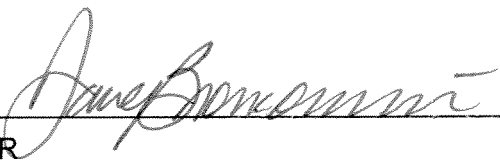

MAYOR
SIGNED THIS 12th DAY OF JANUARY, 2009.



ACTING CITY CLERK
SIGNED THIS 12th DAY OF JANUARY, 2009.

AMENDMENT LOC2008-0089
BYLAW NUMBER 18D2009

SCHEDULE A

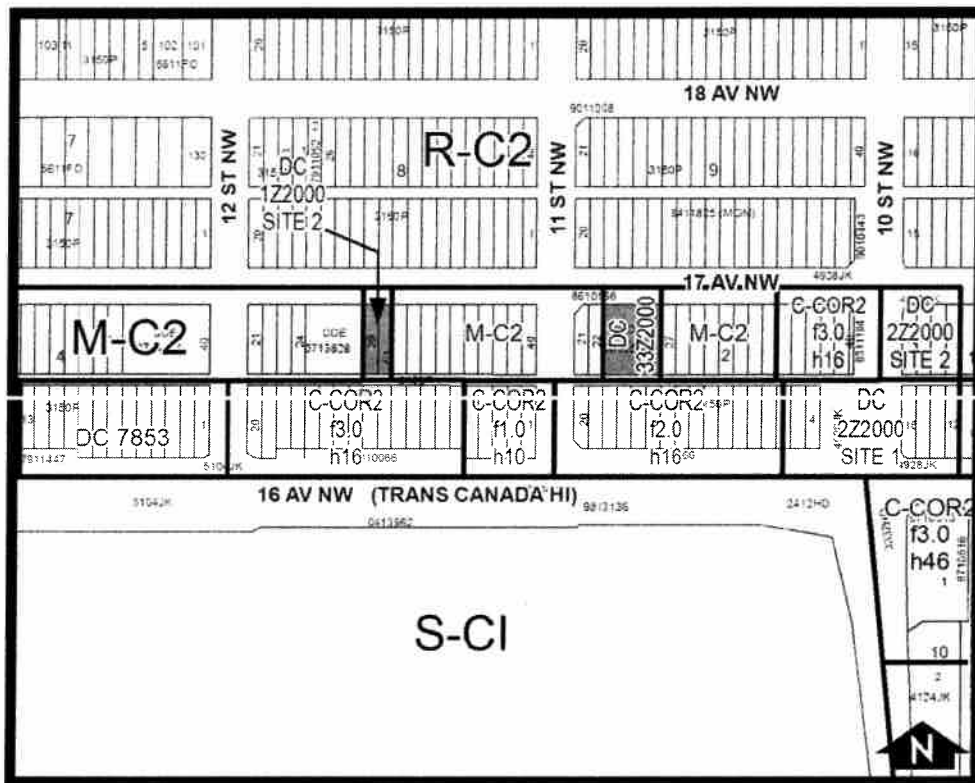

SCHEDULE B

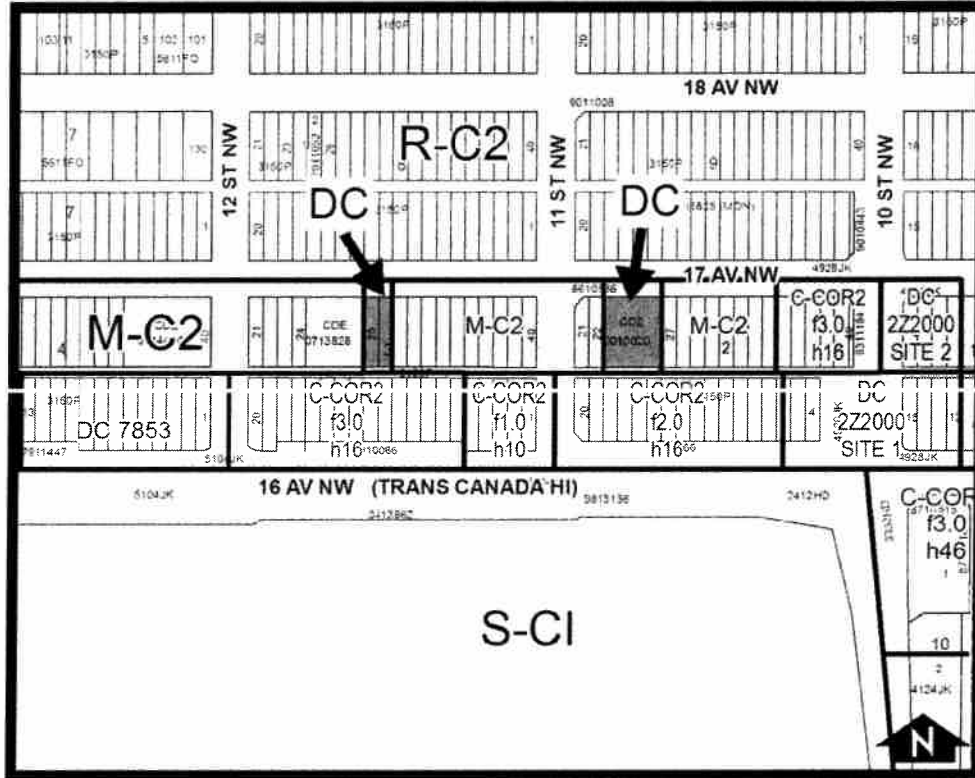

DC DIRECT CONTROL DISTRICT

Purpose

- 1 This Direct Control District is intended to:

Allow **Medical Clinics** in addition to the **uses** of the Multi-Residential—Contextual Medium Profile (M-C2) District.

Compliance with Bylaw 1P2007

- 2 Unless otherwise specified, the rules and provisions of Parts 1, 2, 3 and 4 of Bylaw 1P2007 apply to this Direct Control District.

AMENDMENT LOC2008-0089
BYLAW NUMBER 18D2009

Reference to Bylaw 1P2007

- 3 Within this Direct Control District, a reference to a section of Bylaw 1P2007 is deemed to be a reference to the section as amended from time to time.

Permitted Uses

- 4 The *permitted uses* of the Multi-Residential—Contextual Medium Profile (M-C2) District of Bylaw 1P2007 are the *permitted uses* in this Direct Control District.

Discretionary Uses

- 5 The *discretionary uses* of the Multi-Residential—Contextual Medium Profile (M-C2) District of Bylaw 1P2007 are the *discretionary uses* in this Direct Control District with the addition of:

- (j) **Medical Clinic**

Bylaw 1P2007 District Rules

- 6 Unless otherwise specified, the rules of the Multi-Residential—Contextual Medium Profile (M-C2) District of Bylaw 1P2007 apply in this Direct Control District.

Location of Uses

- 7 **Medical Clinics** shall not be located above any **Dwelling Units** and must be located on the first 2 *storeys* of a *building* only.

Required Motor Vehicle Parking Stalls

- 8 (a) Required parking must be provided in accordance with Bylaw 1P2007; and
(b) Parking access for a **medical clinic** must be provided from the lane only.