

BYLAW NUMBER 95D2010

**BEING A BYLAW OF THE CITY OF CALGARY
TO AMEND THE LAND USE BYLAW 1P2007
(LAND USE AMENDMENT LOC2010-0036)**

WHEREAS it is desirable to amend the Land Use Bylaw Number 1P2007 to change the land use designation of certain lands within the City of Calgary;

AND WHEREAS Council has held a public hearing as required by Section 692 of the Municipal Government Act, R.S.A. 2000, c.M-26 as amended;

NOW, THEREFORE, THE COUNCIL OF THE CITY OF CALGARY ENACTS AS FOLLOWS:

1. The Land Use Bylaw, being Bylaw 1P2007 of the City of Calgary, is hereby amended by deleting that portion of the Land Use District Map shown as shaded on Schedule "A" to this Bylaw and substituting therefor that portion of the Land Use District Map shown as shaded on Schedule "B" to this Bylaw, including any land use designation, or specific land uses and development guidelines contained in the said Schedule "B".
2. This Bylaw comes into force on the date it is passed.

READ A FIRST TIME THIS 26TH DAY OF JULY, 2010.

READ A SECOND TIME THIS 26TH DAY OF JULY, 2010.

READ A THIRD TIME THIS 26TH DAY OF JULY, 2010.



MAYOR
SIGNED THIS 26TH DAY OF JULY, 2010.



ACTING CITY CLERK
SIGNED THIS 26TH DAY OF JULY, 2010.

SCHEDULE A

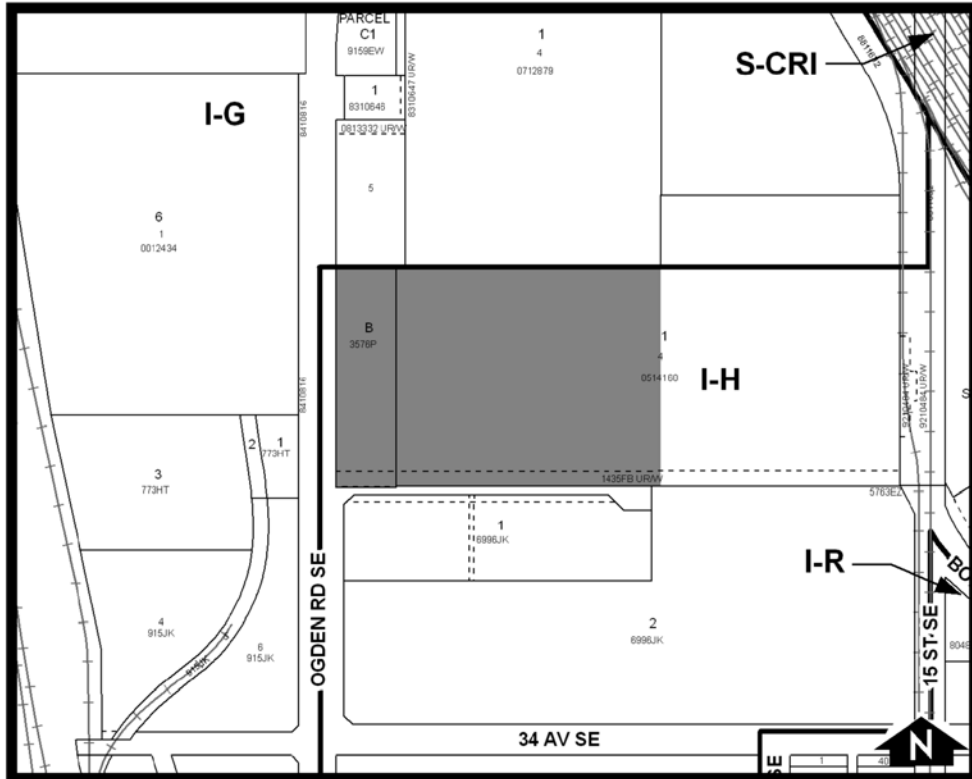

SCHEDULE B

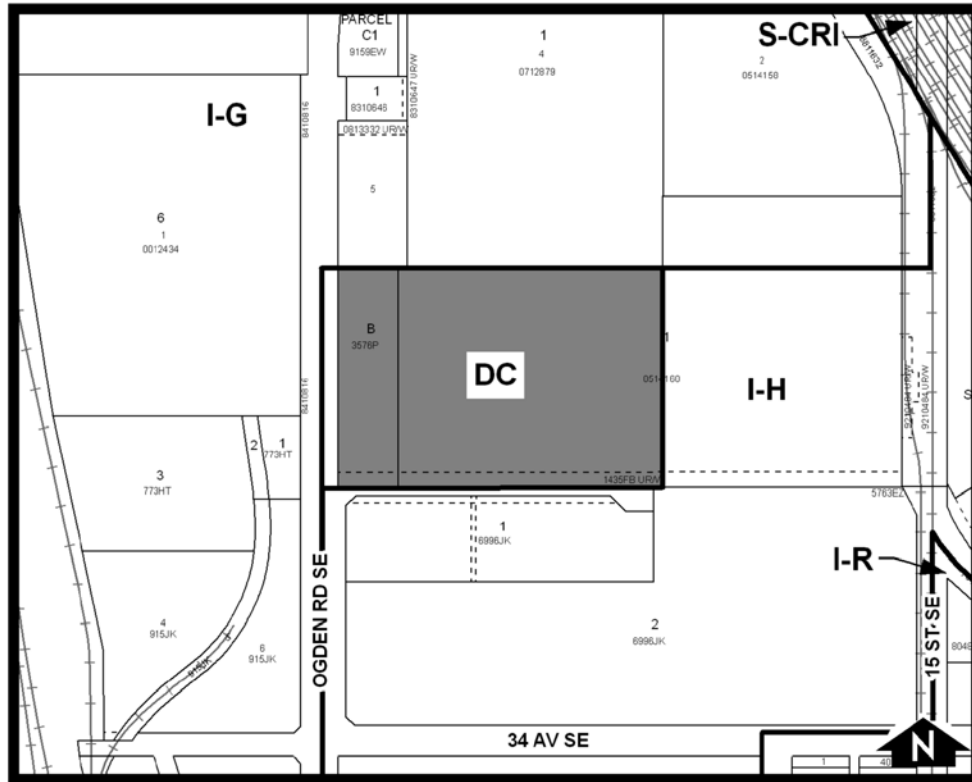

DC DIRECT CONTROL DISTRICT

Purpose

- 1 This Direct Control District is intended to accommodate additional **uses**.

Compliance with Bylaw 1P2007

- 2 Unless otherwise specified, the rules and provisions of Parts 1, 2, 3 and 4 of Bylaw 1P2007 apply to this Direct Control District.

Reference to Bylaw 1P2007

- 3 Within this Direct Control District, a reference to a section of Bylaw 1P2007 is deemed to be a reference to the section as amended from time to time.

General Definitions

4 In this Direct Control District:

- (a) “**stack**” means a vertical structure that acts as the exhaust for a gas turbine.

Permitted Uses

5 The **permitted uses** of the Industrial - Heavy (I-H) District of Bylaw 1P2007 are the **permitted uses** in this Direct Control District with the addition of:

- (a) **Power Generation Facility – Large.**

Discretionary Uses

6 The **discretionary uses** of the Industrial - Heavy (I-H) District of Bylaw 1P2007 are the **discretionary uses** in this Direct Control District with the addition of:

- (a) **Equipment Yard;** and
- (b) **Storage Yard.**

Bylaw 1P2007 District Rules

7 Unless otherwise specified, the rules of the Industrial - Heavy (I-H) District of Bylaw 1P2007 apply in this Direct Control District.

Building Height

8 The maximum **building height** is 50.0 metres.

Stack Height

9 The maximum **stack** height from **grade** is 70.0 metres.