

BYLAW NUMBER 10D2011

**BEING A BYLAW OF THE CITY OF CALGARY
TO AMEND THE LAND USE BYLAW 1P2007
(LAND USE AMENDMENT LOC2010-0052)**

WHEREAS it is desirable to amend the Land Use Bylaw Number 1P2007 to change the land use designation of certain lands within the City of Calgary;

AND WHEREAS Council has held a public hearing as required by Section 692 of the Municipal Government Act, R.S.A. 2000, c.M-26 as amended;

NOW, THEREFORE, THE COUNCIL OF THE CITY OF CALGARY ENACTS AS FOLLOWS:

1. The Land Use Bylaw, being Bylaw 1P2007 of the City of Calgary, is hereby amended by deleting that portion of the Land Use District Map shown as shaded on Schedule "A" to this Bylaw and substituting therefor that portion of the Land Use District Map shown as shaded on Schedule "B" to this Bylaw, including any land use designation, or specific land uses and development guidelines contained in the said Schedule "B".
2. This Bylaw comes into force on the date it is passed.

READ A FIRST TIME THIS 10TH DAY OF JANUARY, 2011.

READ A SECOND TIME, AS AMENDED, THIS 10TH DAY OF JANUARY, 2011.

READ A THIRD TIME, AS AMENDED, THIS 10TH DAY OF JANUARY, 2011.

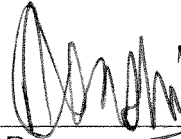

MAYOR
SIGNED THIS 14TH DAY OF JANUARY, 2011.



ACTING CITY CLERK
SIGNED THIS 14TH DAY OF JANUARY, 2011.

AMENDMENT LOC2010-0052
BYLAW NUMBER 10D2011

SCHEDULE A

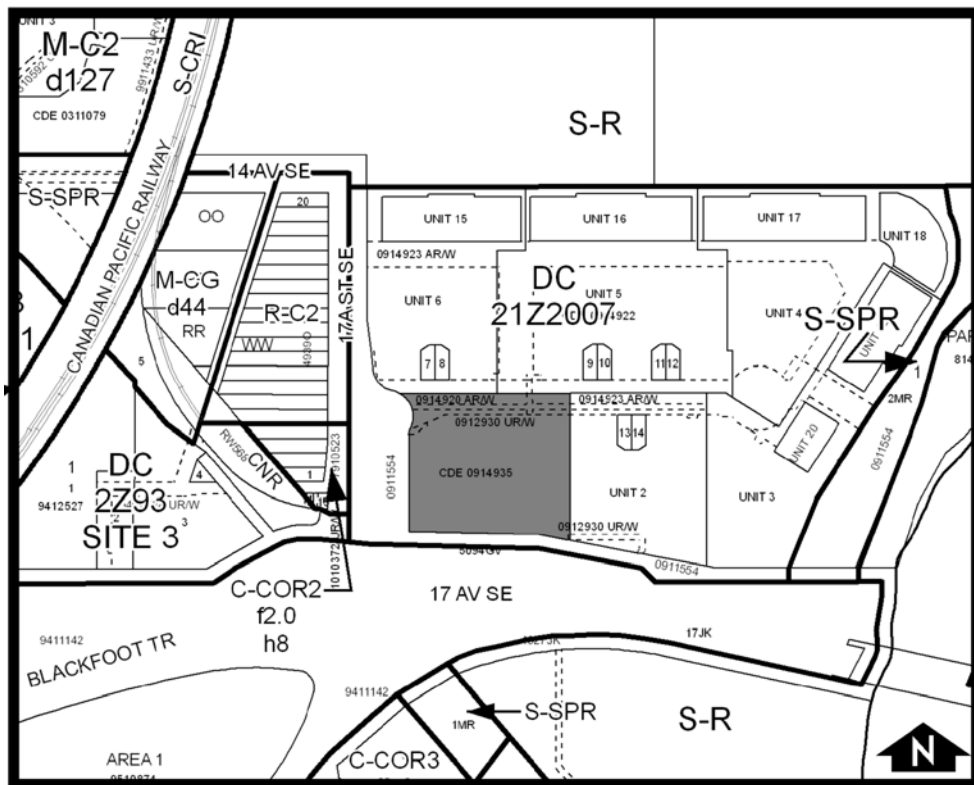

SCHEDULE B

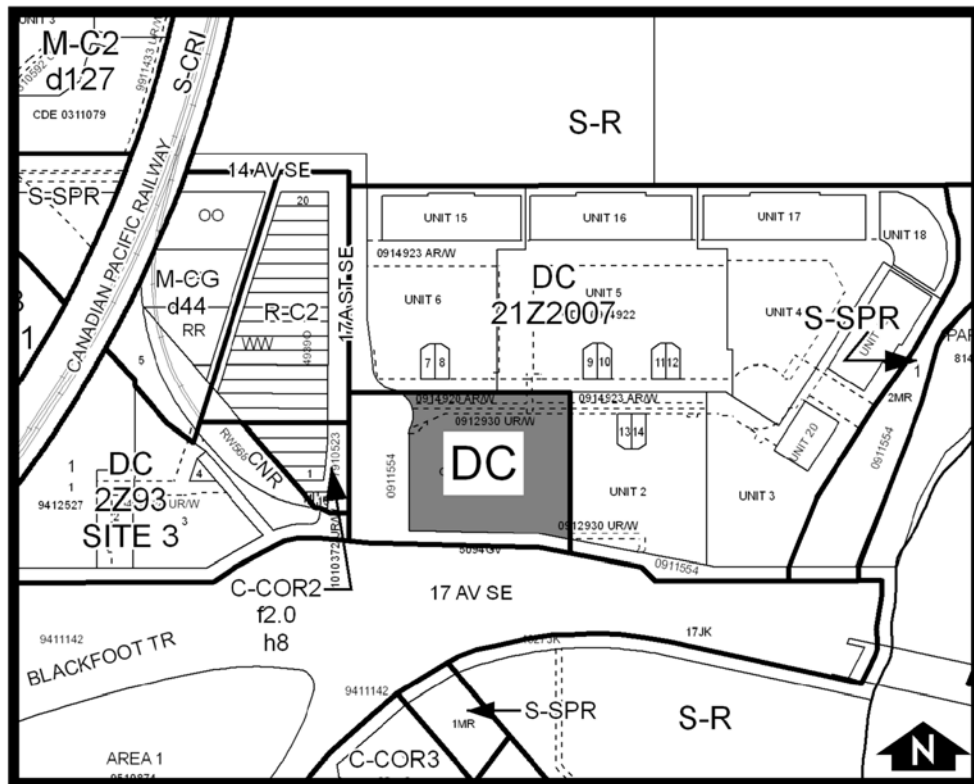

DC DIRECT CONTROL DISTRICT

Purpose

1 This Direct Control District is intended to:

- (a) provide for **Multi-Residential Development** and limited **Medical Clinic** and food service only restaurant **uses**.

**AMENDMENT LOC2010-0052
BYLAW NUMBER 10D2011**

Compliance with Bylaw 1P2007

- 2 Unless otherwise specified, the rules and provisions of Parts 1, 2, 3 and 4 of Bylaw 1P2007 apply to this Direct Control District.

Reference to Bylaw 1P2007

- 3 Within this Direct Control District, a reference to a section of Bylaw 1P2007 is deemed to be a reference to the section as amended from time to time.

Permitted Uses

- 4 The **permitted uses** of the Multi-Residential – High Density Low Rise (M-H1) District of Bylaw 1P2007 are the **permitted uses** in this Direct Control District.

Discretionary Uses

- 5 The following **uses** are **discretionary uses** in this Direct Control District:

- (a) **Addiction Treatment;**
- (b) **Assisted Living;**
- (c) **Custodial Care;**
- (d) **Home Occupation – Class 2**
- (e) **Live Work Unit;**
- (f) **Medical Clinic;**
- (g) **Multi-Residential Development;**
- (h) **Restaurant: Food Service Only – Medium;**
- (i) **Restaurant: Food Service Only – Small;**
- (j) **Sign - Class B;**
- (k) **Sign - Class C;**
- (l) **Sign - Class D;**
- (m) **Sign - Class E;**
- (n) **Temporary Residential Sales Centre; and**
- (o) **Utility Building.**

Bylaw 1P2007 District Rules

- 6 Unless otherwise specified, the rules of the Multi-Residential – High Density Low Rise (M-H1) District of Bylaw 1P2007 apply in this Direct Control District.

Density

- 7 The maximum **density** is 186 **units** per hectare in this Direct Control District.

Rules for Medical Clinic and Restaurant Food Service Only

- 8 (1) **Medical Clinic uses** must:
- (a) be located on the floor closest to **grade** or on the **second storey**;
 - (b) be contained completely within the **building**;
 - (c) not be located above any **Dwelling Unit**;
 - (d) not share an internal hallway with **Dwelling Units**; and
 - (e) have a separate exterior entrance from that of the **Dwelling Units**.
- (2) The maximum **gross floor area** for all **Medical Clinic uses** is 100.0 square metres.

**AMENDMENT LOC2010-0052
BYLAW NUMBER 10D2011**

- (3) **Restaurant: Food Service Only – Medium** and **Restaurant: Food Service Only – Small uses** must:
- (a) be located on the floor closest to **grade**;
 - (b) be contained completely within the **building**;
 - (c) not be located above any **Dwelling Unit**;
 - (d) not share an internal hallway with **Dwelling Units**; and
 - (e) have a separate exterior entrance from that of the **Dwelling Units**.
- (4) The maximum combined **gross floor area** for **Restaurant: Food Service Only – Medium** and **Restaurant: Food Service Only – Small uses** is 130.0 square metres.