

EXAMPLE OF PROPOSED CONSTRUCTION ASSEMBLIES

FLOOR/CEILING

- FINISHED FLOORING
- 3/4" PLYWOOD GLUED & SCREWED
- EXISTING FLOOR SYSTEM
- 1/2" GYPSUM BOARD MUD AND TAPED

INTERIOR WALLS

- 1/2" GYPSUM BOARD MUD AND TAPED
- 2x4" STUDS @ 24" O/C
- 1/2" GYPSUM BOARD MUD AND TAPED

FOUNDATION WALLS

- EXTERIOR DAMP-PROOFING BELOW GRADE
- 8" CONCRETE WALL
- 2x4 STUD @ 24" OC
- R-12 BATT INSULATION
- 6 mil VAPOUR BARRIER
- 1/2" GYPSUM BOARD MUD AND TAPED

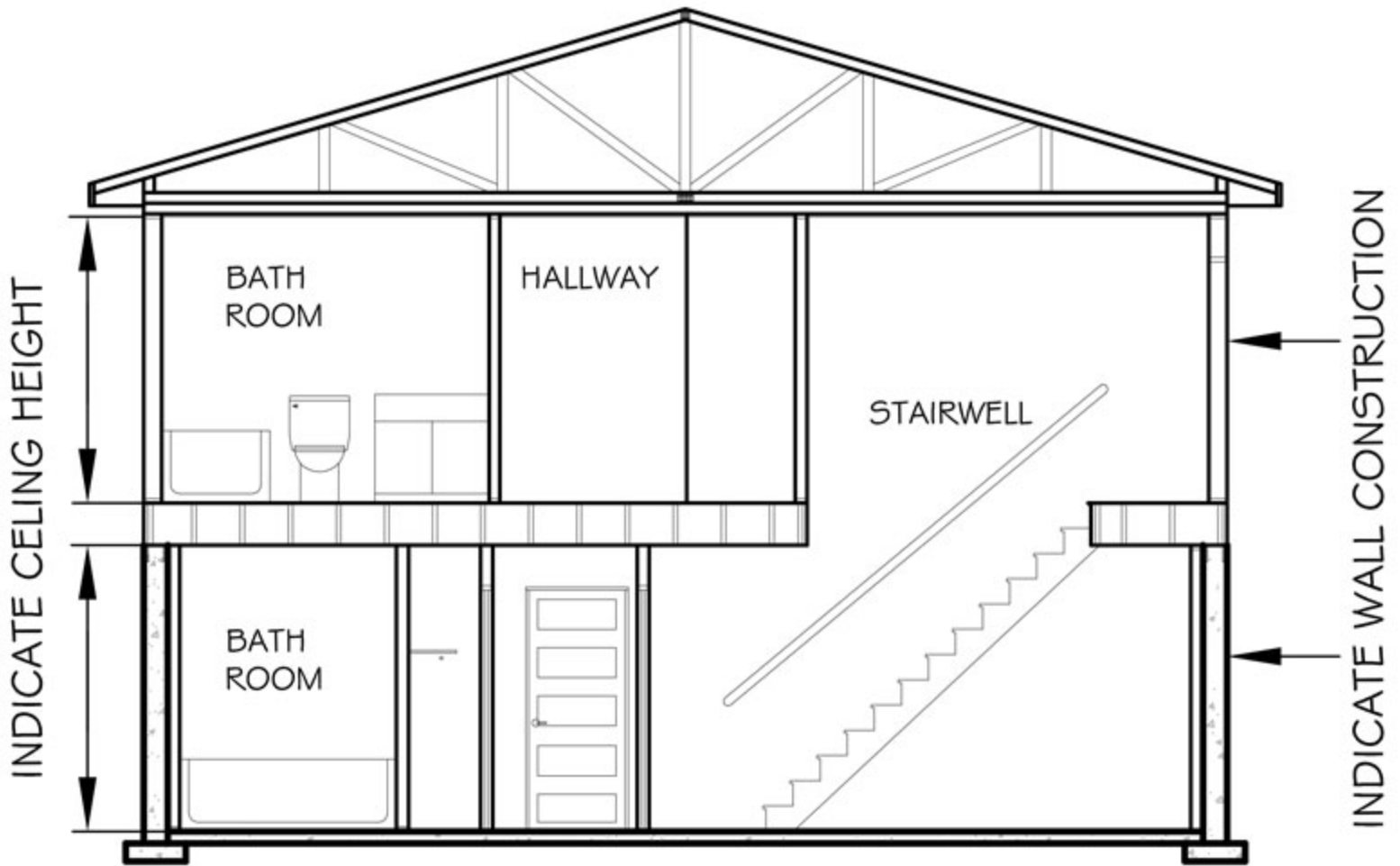

	SAMPLE CROSS SECTION	DATE: MARCH 3, 2016
	ADDRESS: 1 23 FOUR ST NW	SCALE: $\frac{3}{16}'' = 1'$