

# WANDER

Much of our lives are centered around our hectic everyday routines. The current context that we find ourselves in has further blurred the boundary between work and life. We find ourselves longing for the past, for times that were simpler. In times of uncertainty, nostalgia acts as a form of self-care, giving us access to happier memories. *Wander* will work as a magical portal to help individuals escape to a transcendent world of light and colour, like seeing the wonders of our reality through a child's eyes. By reinventing the mechanism of a kaleidoscope into an interactive multi-sensory installation, users can stop and take a moment to awaken their inner child. Through this installation we encourage people from different walks of life to pause and think about what the little things that bring them joy are. *Wander* is an inclusive and fun experience for all ages and abilities. The kaleidoscope feature combines with urban furniture to function as a way-finding tool connecting the 8th street C-train station and 8th Avenue through Century Gardens Park both during the day and providing an additional inviting light source at night. Using a biodegradable filament to 3D print the shell of this installation, the structure is sustainable, lightweight, and simple to fabricate. The wooden benches add weight and support to the structure making it durable against winter weather and public interaction.

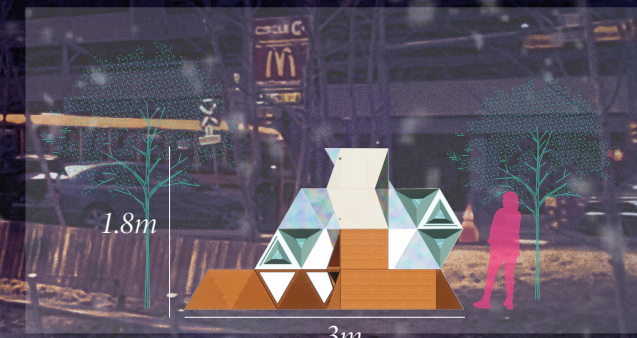

Kaleidoscope Close Up



Front Elevation

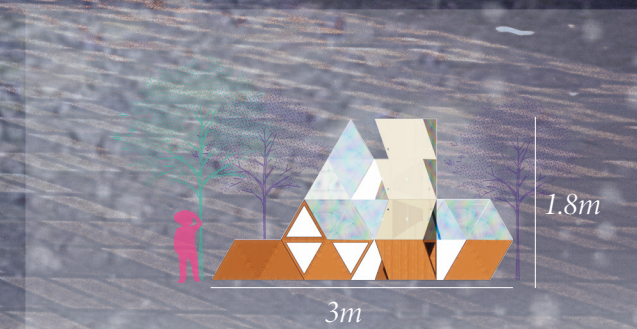

Side Elevation

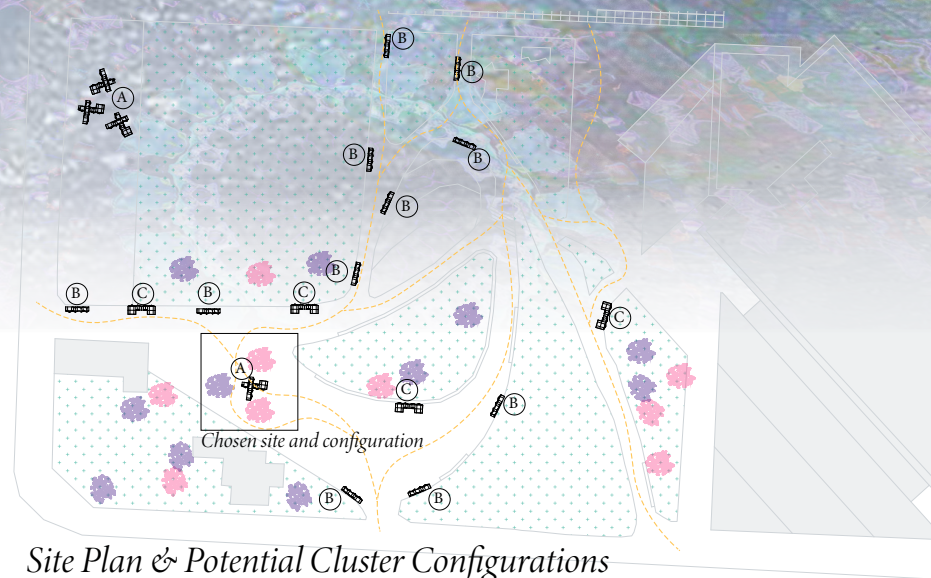

Site Plan & Potential Cluster Configurations

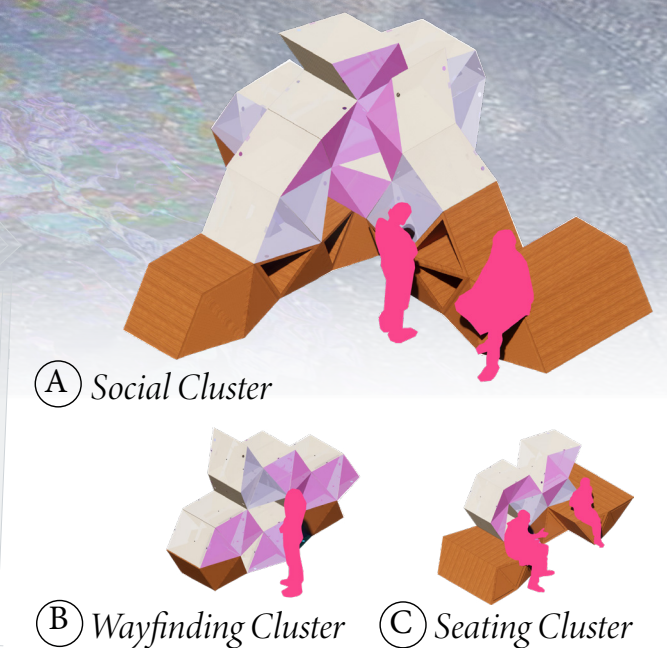

(A) Social Cluster

(B) Wayfinding Cluster

(C) Seating Cluster

## Unit Construction and Materials

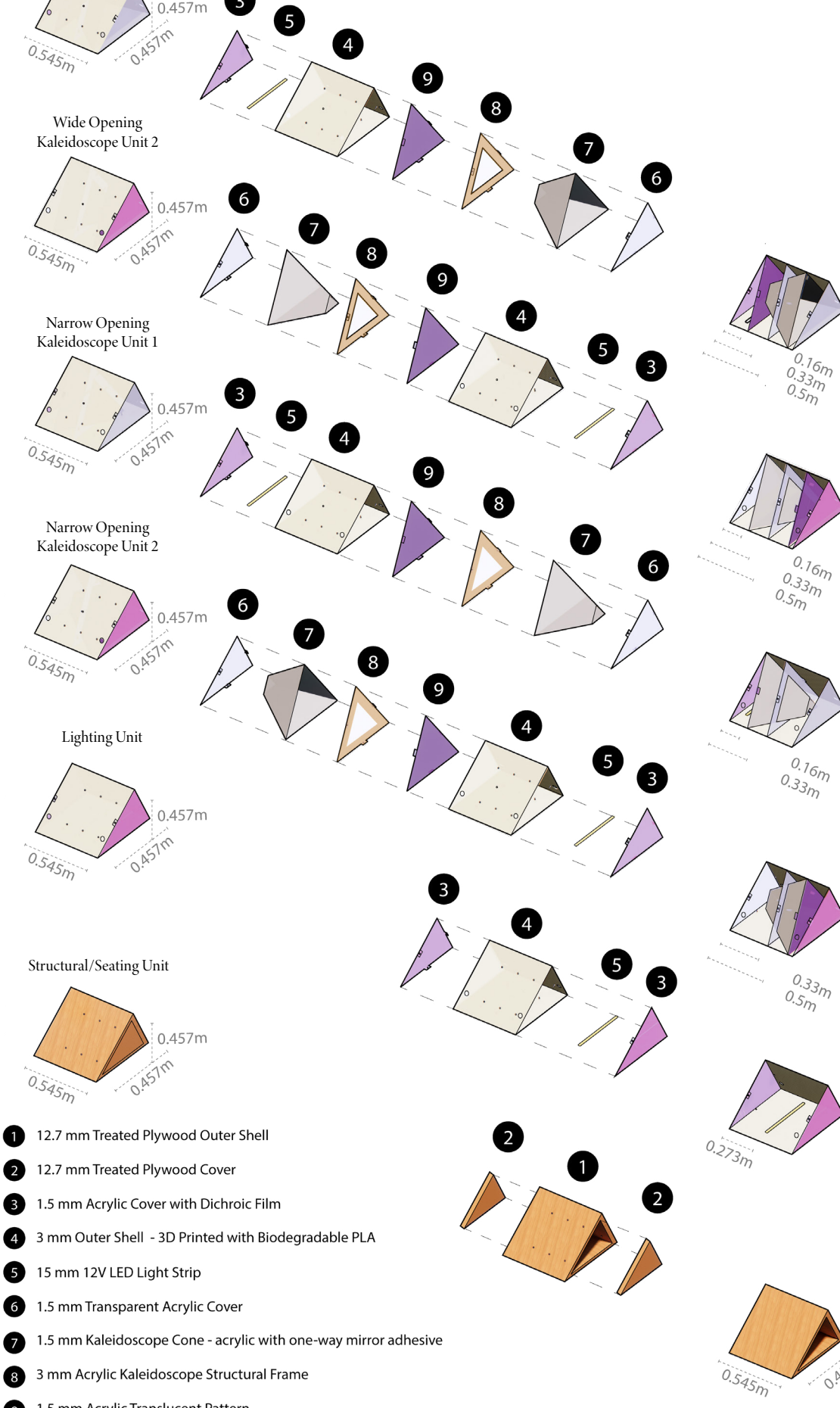

- 1 12.7 mm Treated Plywood Outer Shell
- 2 12.7 mm Treated Plywood Cover
- 3 1.5 mm Acrylic Cover with Dichroic Film
- 4 3 mm Outer Shell - 3D Printed with Biodegradable PLA
- 5 15 mm 12V LED Light Strip
- 6 1.5 mm Transparent Acrylic Cover
- 7 1.5 mm Kaleidoscope Cone - acrylic with one-way mirror adhesive
- 8 3 mm Acrylic Kaleidoscope Structural Frame
- 9 1.5 mm Acrylic Translucent Pattern

## Cluster Programming and Wiring

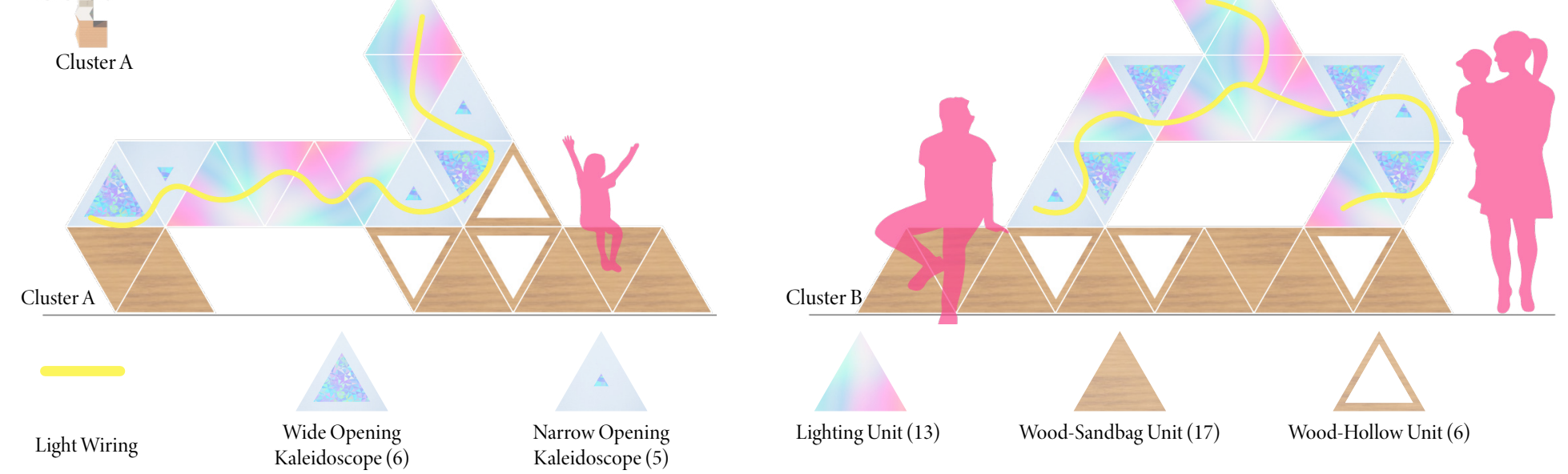

## Wiring Scenarios

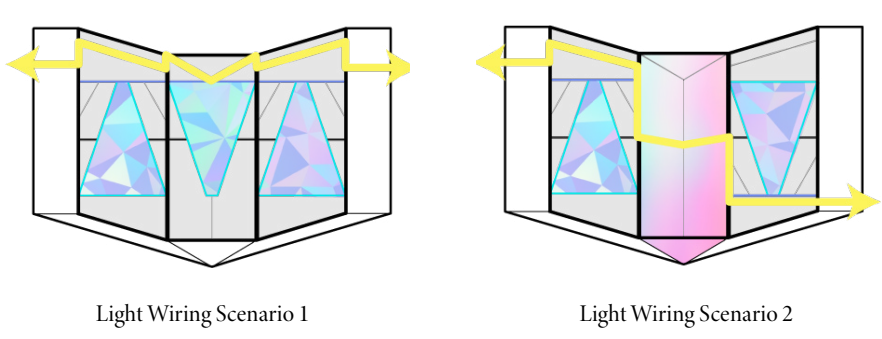

## Unit Connections

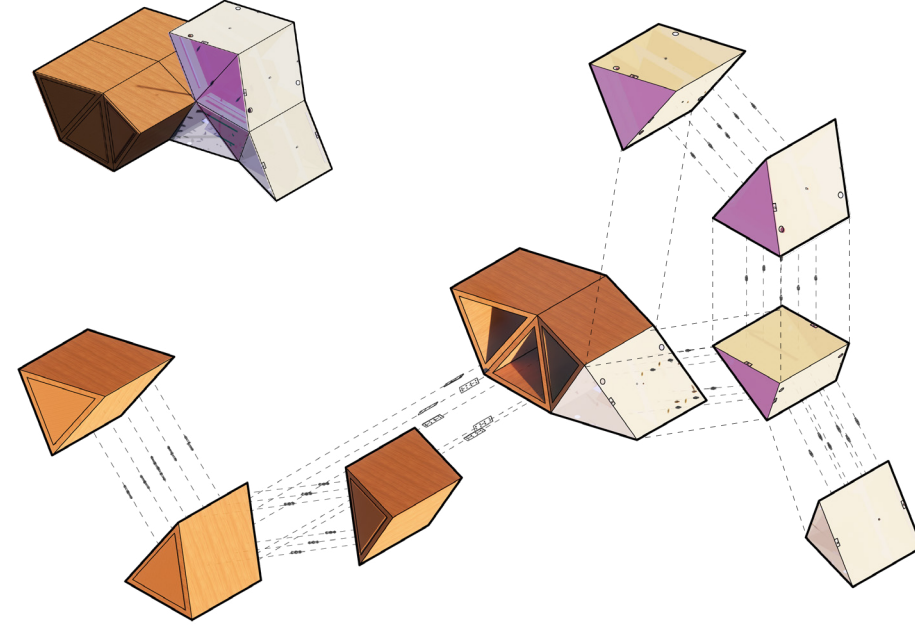

## Budgeting

<b>Materials</b>	<b>60%</b>
Lighting	\$120
Acrylic Cover	\$1,500
Biodegradable PLA Plastic Shell	\$2,000
Dichroic Adhesive Film for Kaleidoscopes Pattern	\$430
One-way Window Adhesive Reflective Film for Kaleidoscopes	\$150
Treated Wood for Bottom/Seating Units	\$1,000
Miscellaneous Assembly Materials	\$800
<b>Labour</b>	<b>20%</b>
<b>Artist Fee</b>	<b>10%</b>
<b>Contingency</b>	<b>10%</b>
<b>Total: \$10,000</b>	