



SITE CROSS-SECTION A-A  
SCALE 1:100



# FLOW

## OVER PARK

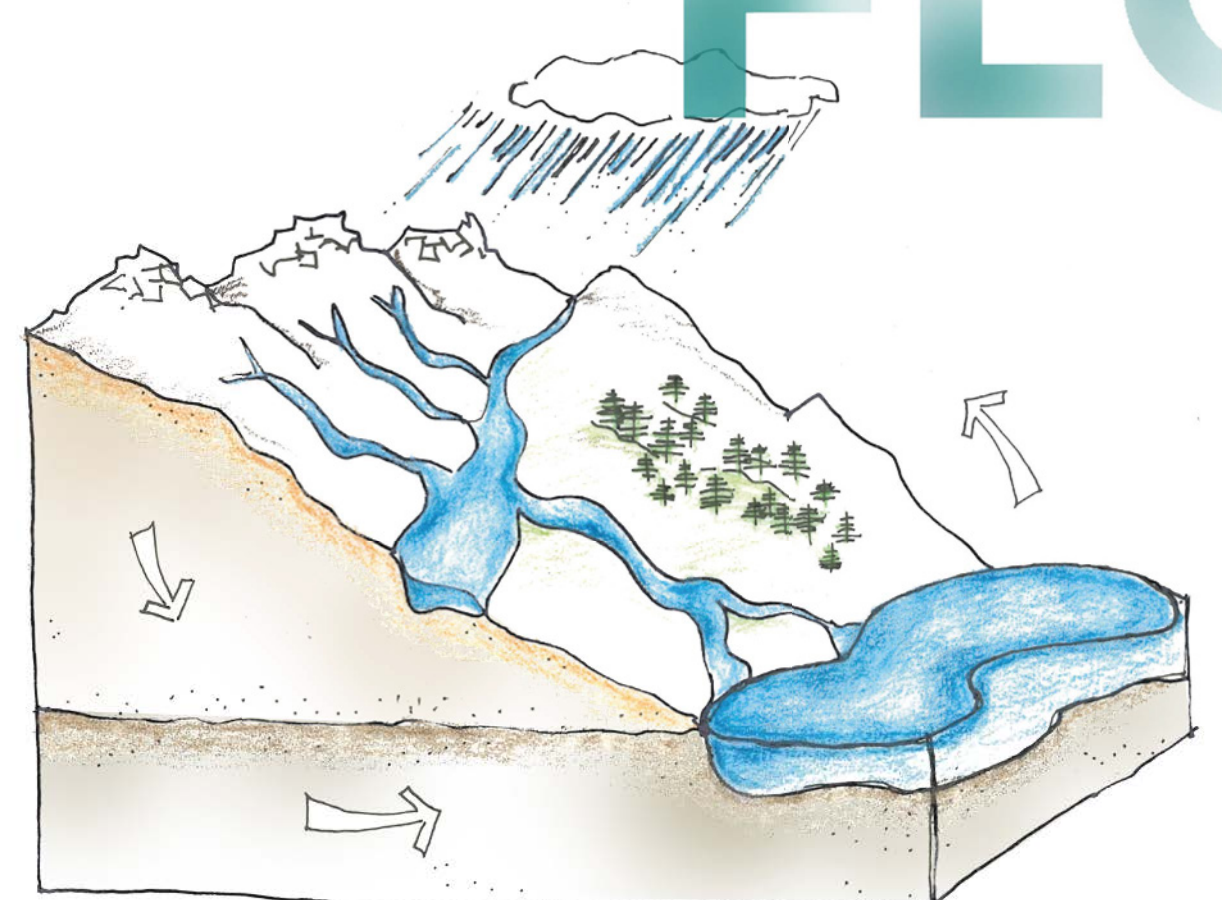

**Flow-over Park transforms a 'left-over' space into a magical place.**  
It uses vegetation, creative lighting, natural play elements, green infrastructure, and a variety of unique social spaces to create a safe and welcoming environment for all its users, and serves as a bold and positive gateway to the community of Bridgeland.

Flow Over Park provides an abundance of natural play opportunities that mimic the natural environment: there are boulders to climb on the slopes with a slide at the top and there are logs scattered throughout the site where children and adults alike can test their balance. The fly-over provides a unique opportunity and the park takes advantage of this opportunity by suspending a hanging rope for those who have always wanted to let out their inner Tarzan, and a number of logs that can be used as swaying benches or more unique play opportunities. The park also provides a pump that can be used for creative play or for providing safe drinking water for passersby and park users.

The park also serves a functional purpose - rainwater is collected through a series of swales that treat the polluted water from the streets before it eventually infiltrates the ground. They are designed large enough that even in a 1:100 storm situation like 2013, they will not be overwhelmed.

The Northwest portion of the site is a flexible space that can allow for programming and events, food trucks, markets, and community gardening space.

The recessed amphitheatre can serve as an outdoor classroom for nearby students when the weather cooperates and as a skating rink in the winter. In addition to its use for socializing, education, and active recreation - it also serves as the primary piece of Green Infrastructure by treating contaminated rainwater through vegetation and its foundation of engineered soils and aggregates.



CONTEXT PLAN



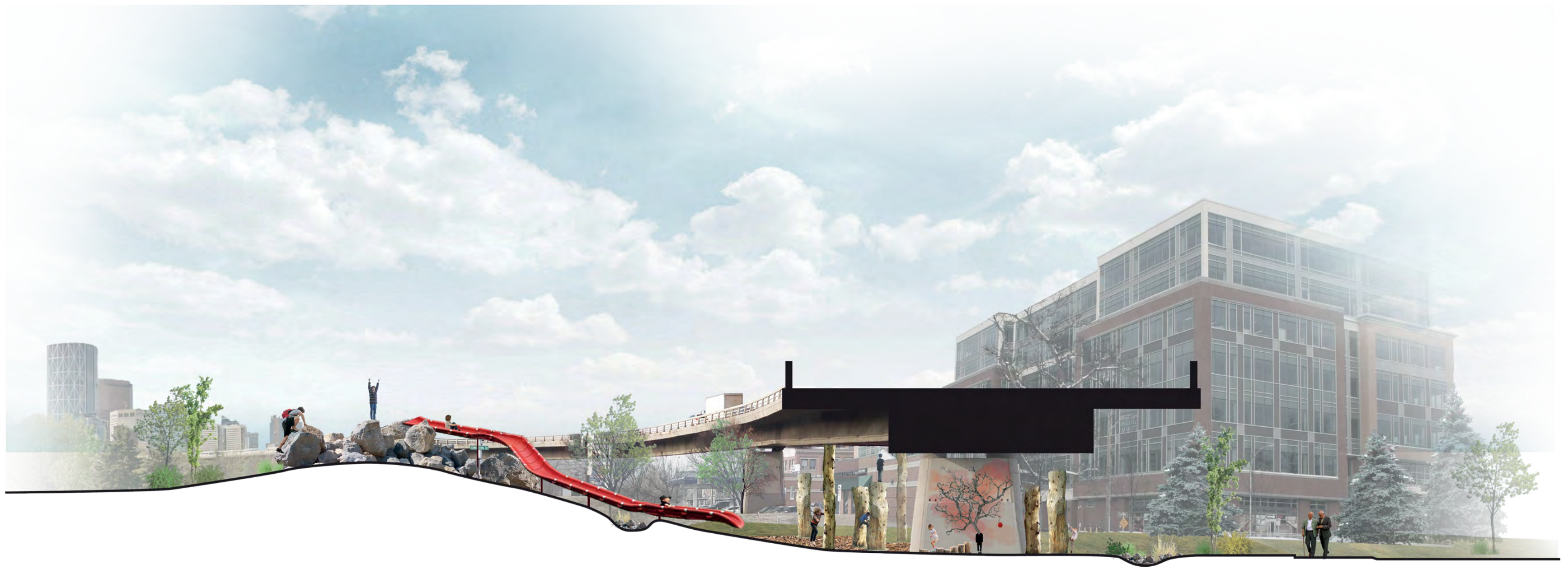

SITE CROSS-SECTION B-B  
SCALE 1:100





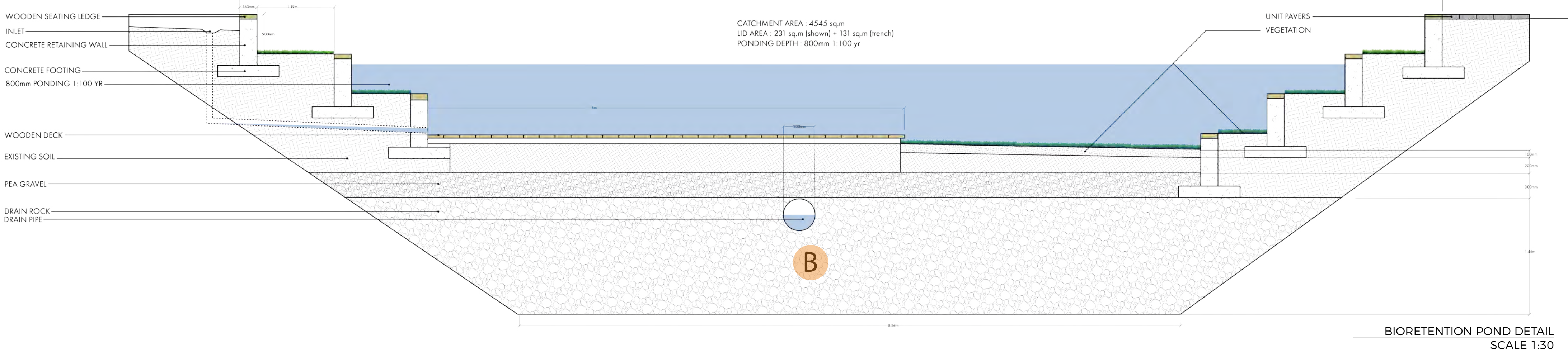

BIORETENTION POND DETAIL  
SCALE 1:30

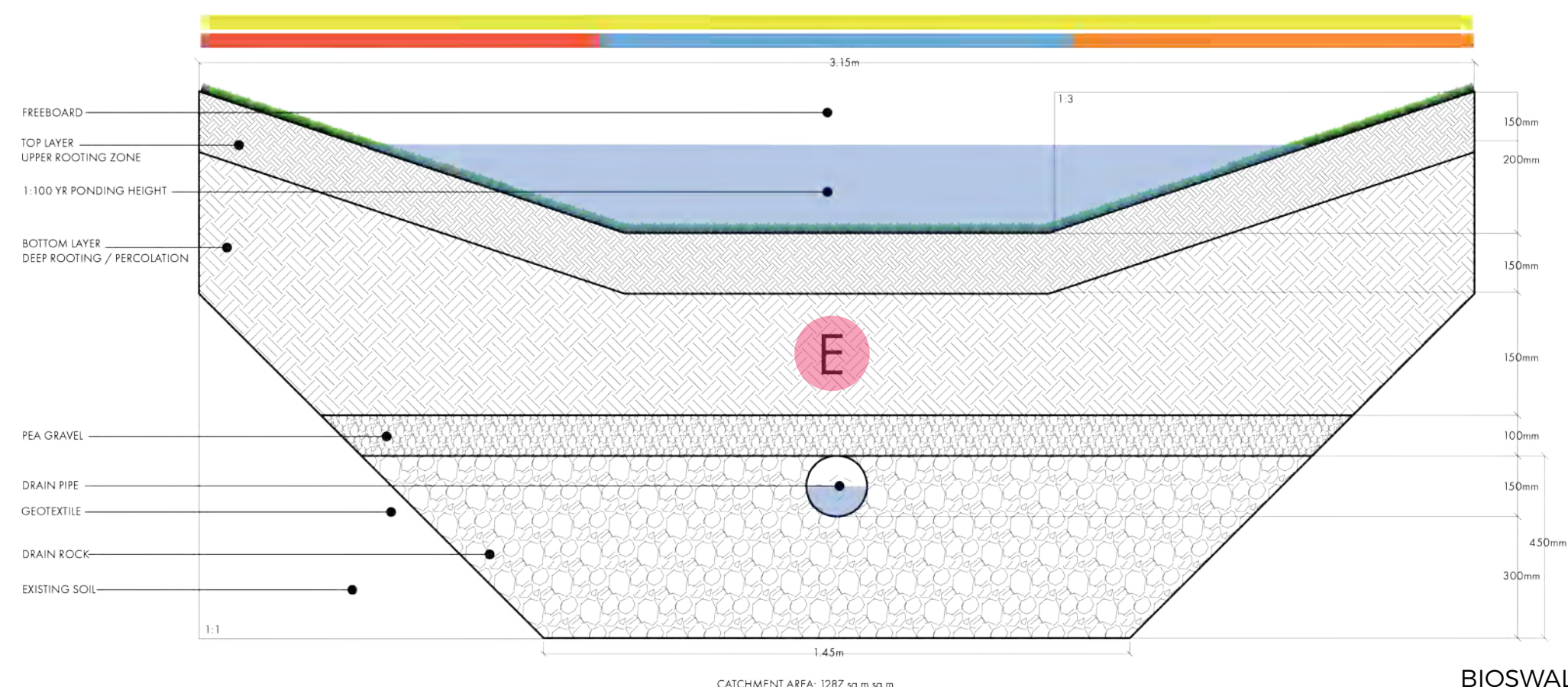
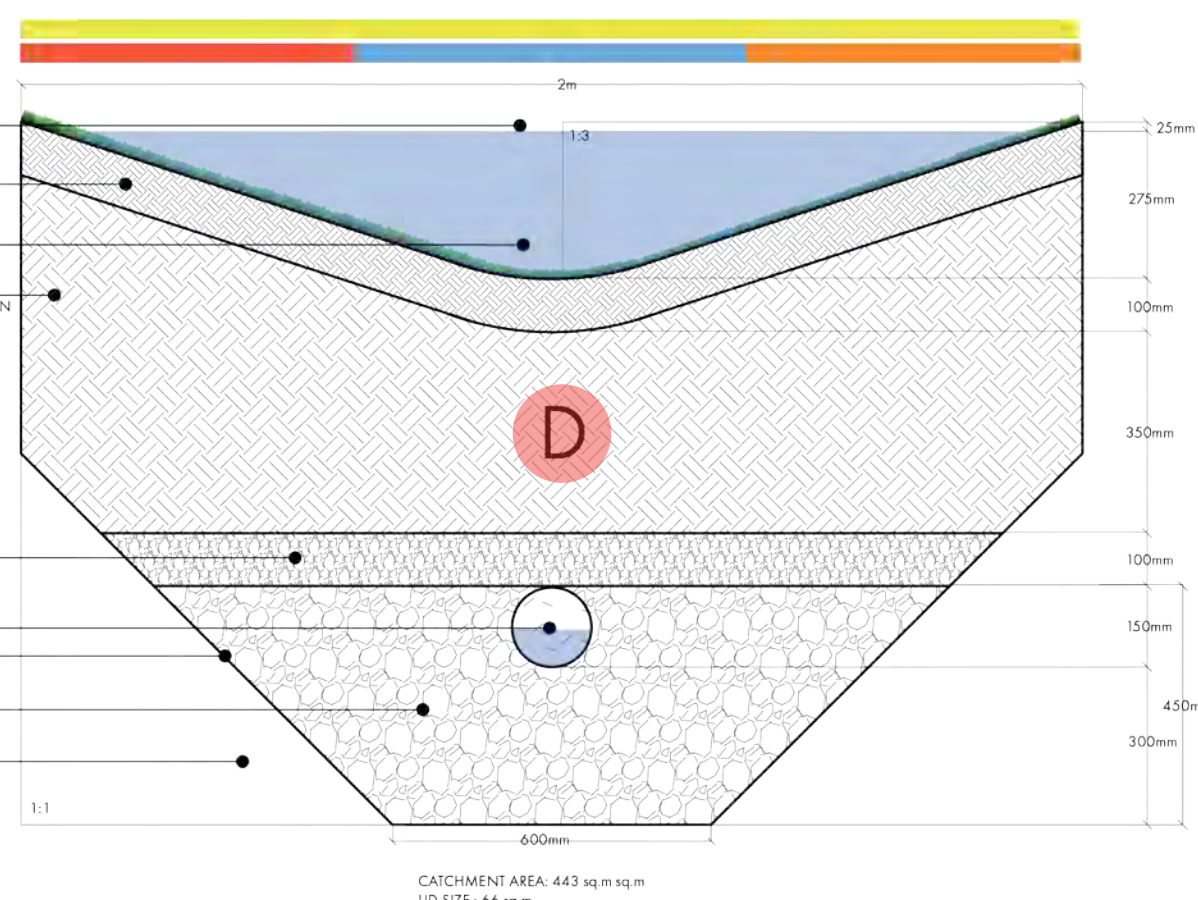
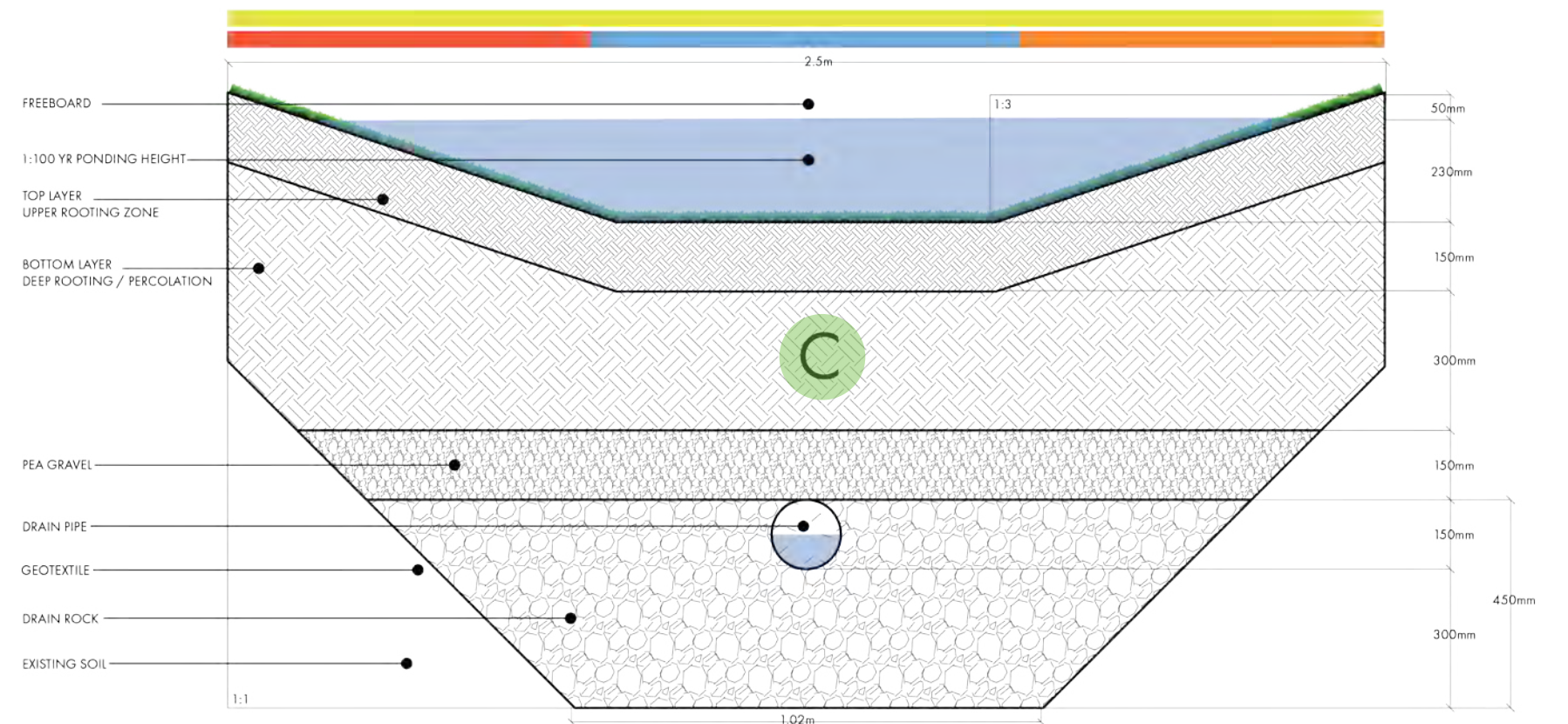
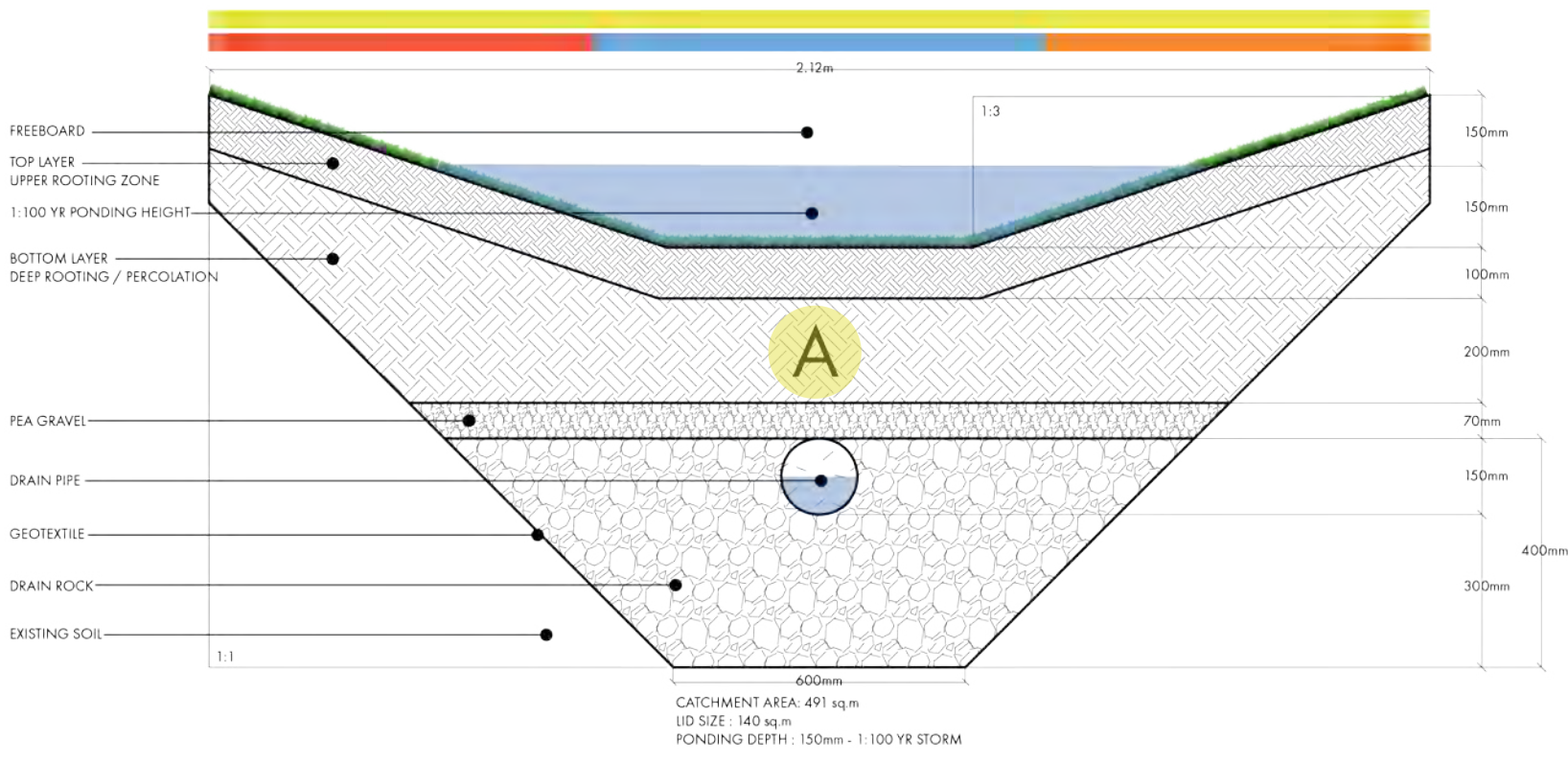

BIOSWALE DETAILS  
SCALE 1:15

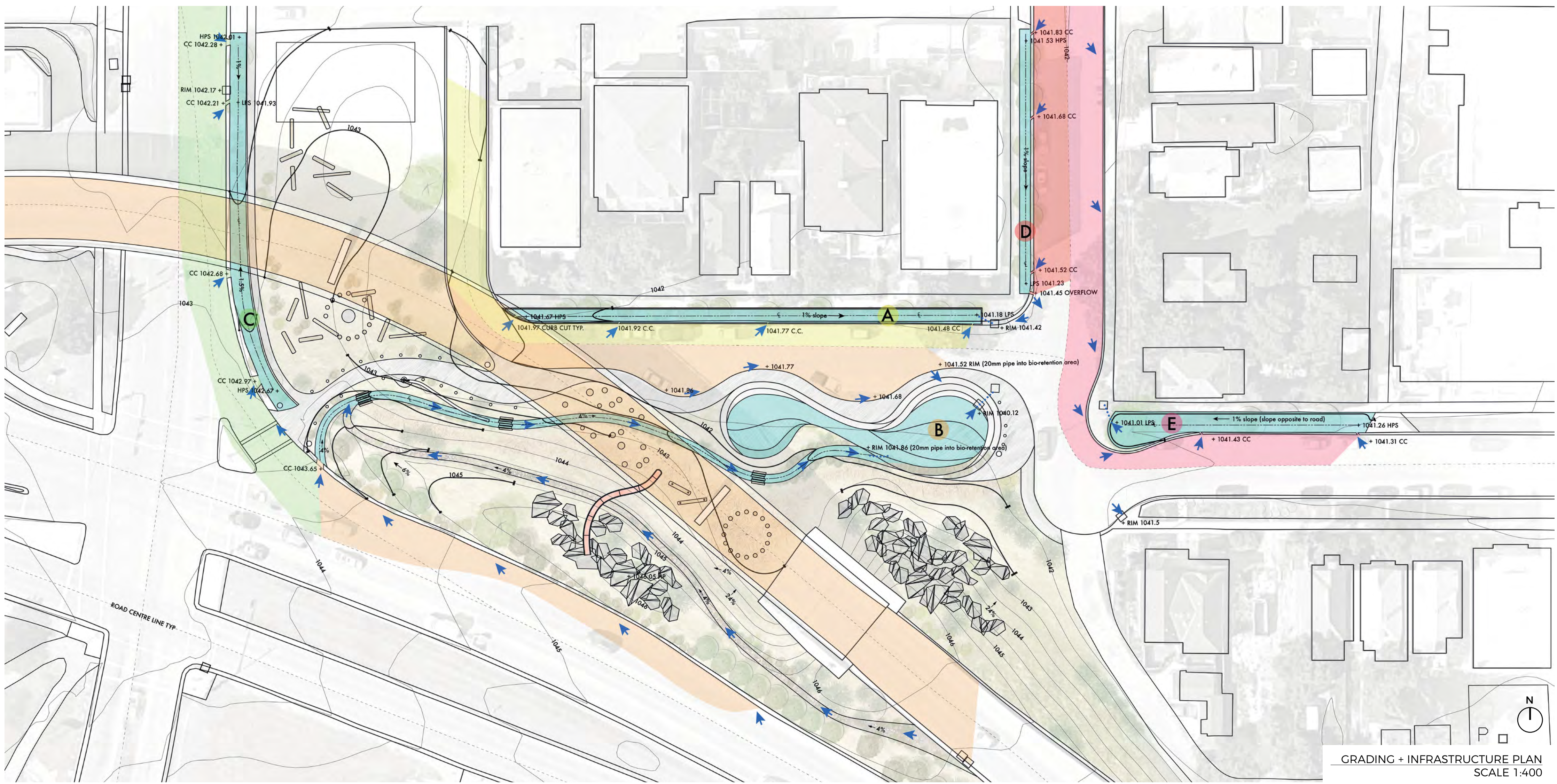

GRADING + INFRASTRUCTURE PLAN  
SCALE 1:400

PLANTING PALETTE	SEASONAL INTEREST											
	J	F	M	A	M	J	J	A	S	O	N	D
<b>FILTER GRASSES</b>												
Red Fescue <i>Festuca Rubra</i>												
Rough Fescue <i>Festuca Scabrella</i>												
Blue Grass <i>Poa Spp</i>												
Sheep Fescue <i>Festuca Ovina</i>												
<b>SEDGES</b>												
Reed Grass <i>Calamagrostis spp</i>												
Rush <i>Juncus spp</i>												
Tufted Hair Grass <i>Deschampsia</i>												
<b>UPLAND SPECIES</b>												
Snow Berry <i>Symphoricarpos Album</i>												
Giant Hyssop <i>Agastache Foeniculum</i>												
Wild Rose <i>Rosa Acicularis</i>												
Wild Bergamot <i>Monarda Fishlosa</i>												
Prairie Coneflower <i>Rudbeckia Cubanelera</i>												
Common Yarrow <i>Achillea Millefolium</i>												
Blackeyed Susan <i>Rudbeckia Hirta</i>												
<b>WET ZONE SPECIES</b>												
Pussy Willow <i>Salix Discolora</i>												
Ostrich Fern <i>Mattuccia Struthiopteris</i>												
Goldenrod <i>Solidago Canadensis</i>												
Cow Parsnip <i>Heraclenum Lanatum</i>												
<b>SALINE RESISTANT</b>												
Alfalfa <i>Medicago Sativa</i>												
Silver Berry <i>Elaeagnus Communita</i>												
Laurel Willow <i>Salix Pentandra</i>												
White Sweet Clover <i>Melilotus Alba</i>												

MAINTENANCE	SEASONAL INTEREST											
	J	F	M	A	M	J	J	A	S	O	N	D
<b>DECIDUOUS TREES</b>												
Pruning												
Once a Year												
<b>CONIFEROUS TREES</b>												
Cutting Low Branches												
Once a Year												
<b>SHRUBS</b>												
Pruning												
Once a Year												
<b>GRASSES</b>												
Cutting												
Once a Year												
<b>GRASS (LAWN)</b>												
Mowing												
Every Two Weeks												
<b>GENERAL</b>												
Visual Inspection												
Clean up Garbage												
Mulch Clearing												
Three Times a Year												

